

**Nouveautés présentées dans ce catalogue**  
**Neuheiten dieses Kataloges**  
**New products introduced in this catalogue**



New references		
Type Typ Type	Ref.	Page Seite Page
<b>BH</b>	BHS4-D16-110-F4	10.10
<b>BB-C45</b>	BB4R/L-0612-C45-E03	10.24
	BB4R/L-0714-C45-E03	
	BB4R/L-0918-C45-E05	
	BB4R/L-2575-C45-E05	
	BB4R/L-35105-C45-E05	
<b>BF-C45</b>	BF4R/L-0612-C45-E03	10.25
	BF4R/L-0714-C45-E03	
	BF4R/L-0918-C45-E05	
	BF4R/L-2575-C45-E05	
	BF4R/L-35105-C45-E05	

APPLITEC

**BH**

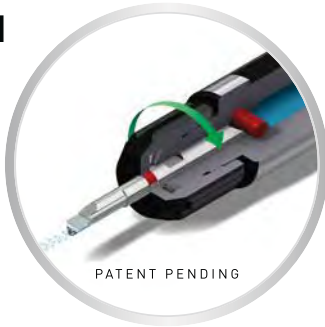

**BHS**

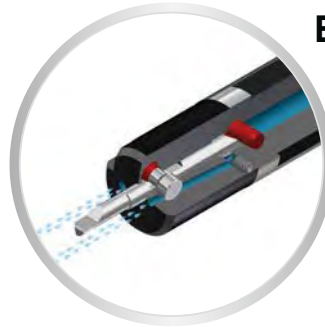



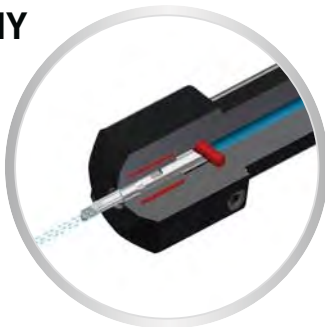

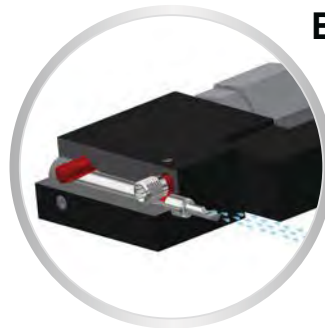

**BHY**



**BHK**

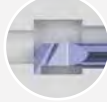
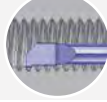
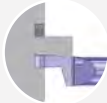

Système de désignation Bezeichnungssystem Designation system	<b>Info</b>		> <b>10.02</b>
Nuances & paramètres de coupe Sorten & Schnittwerte Grades & machining data			> <b>10.08</b>
Porte-outils Halter Holders	<b>BH / BHS / BHY / BHK</b>		> <b>10.10</b>
Alésage Ausbohren Boring	<b>BA / BAX</b>		> <b>10.18</b>
Alésage-copiage Ausbohren-kopieren Boring chambering	<b>BCX</b>		> <b>10.22</b>
Copiage Kopieren Chambering	<b>C45 / C45X</b>		> <b>10.24</b>
Gorge Einstechen Grooving	<b>GX</b>		> <b>10.28</b>
Fonçage-tournage Einstechen und drehen Grooving and turning	<b>GTX</b>		> <b>10.30</b>
Filetage Gewindedrehen Threading	<b>TP60° / TP55° / TM</b>		> <b>10.32</b>
Gorge frontale Axiales Stechen Axial grooving	<b>FEG / FIG</b>	 	> <b>10.38</b>
Ébauches / Jauges d'alignement / Adaptations machines / Accessoires Rohlinge / Richtplatten / Maschinenanpassungen / Zubehöre Blanks / Adjusting tools / Machines adapters / Accessories			> <b>10.40</b>

Système de désignation des porte-outils

Halter Bezeichnungssystem

Holders designation system

## BH / BHS / BHY



**H**

**HS**

**HY**

**B**

**H**

**4**

**-**

**D**

**20**

**-**

**100**

Longueur  
Länge  
Length

Ø queue  
Schaft Ø  
Shank Ø

Queue cylindrique  
Zylindrischer Schaft  
Cylindrical shank

Ø alésage  
Bohrung Ø  
Bore Ø

Porte-outils  
Halter  
Holders

Ligne produit d'alésage  
Innendreihen Produktlinie  
Boring product line

Système de désignation des porte-outils

Halter Bezeichnungssystem

Holders designation system

BHK

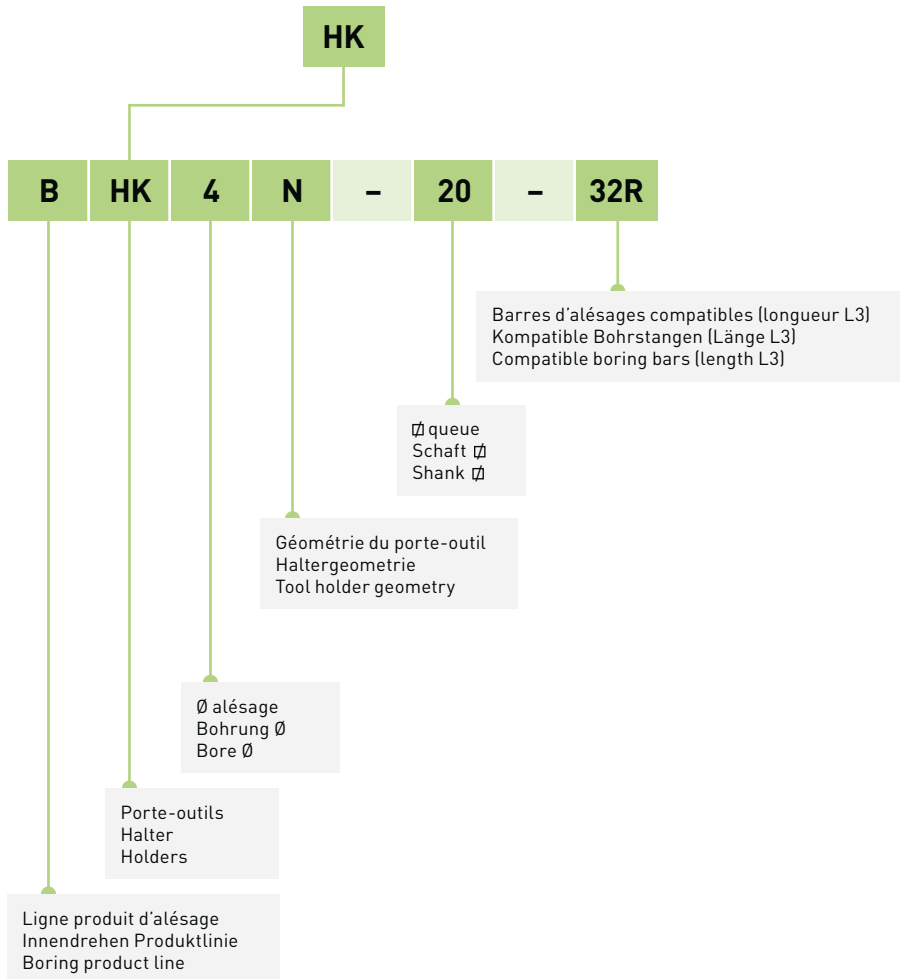
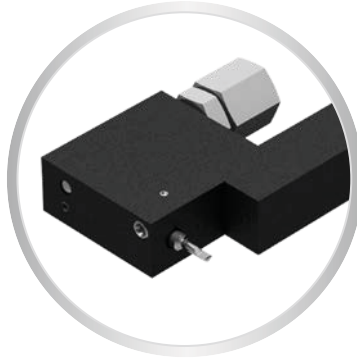

Système de désignation des barres d'alésage

Bohrstangen Bezeichnungssystem

Boring bars designation system

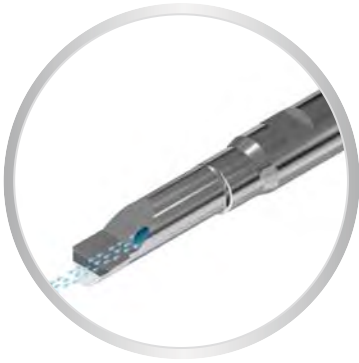

**B**

**F**

**B B 4 R - 25 - 75 - BAX - R05 - ZN**

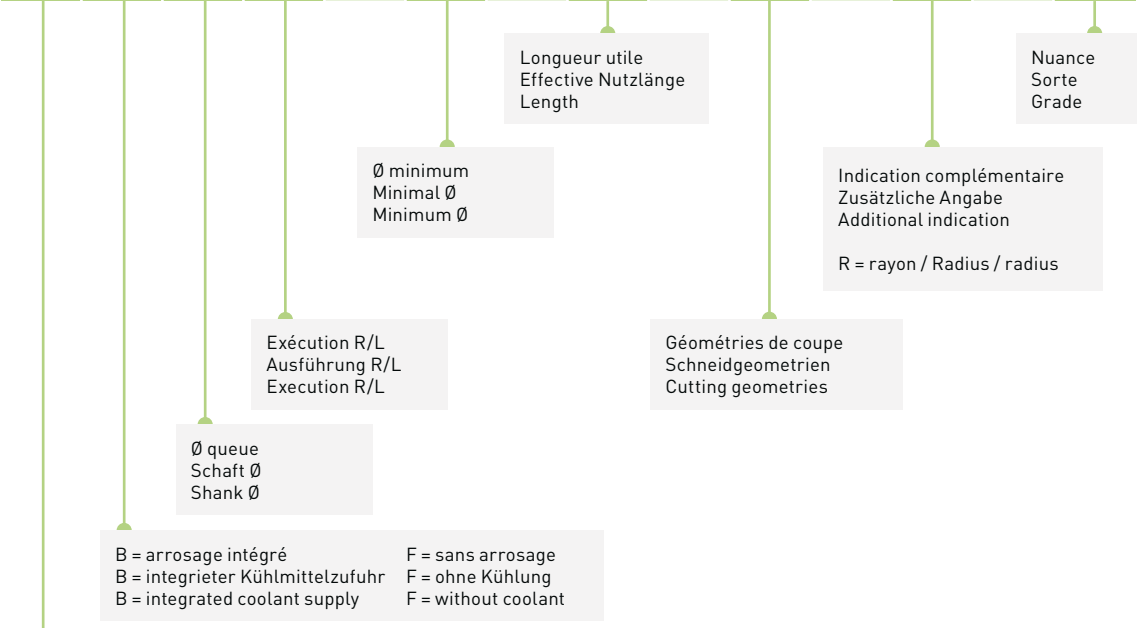

Ligne produit d'alésage  
 Innendrehen Produktlinie  
 Boring product line

Porte-outils avec écrou de serrage

Halter mit Spannmutter

Tool holders with clamping nut

BH

Arrosage par la barre d'alésage

Kühlung durch die Bohrstange

Cooling through the boring bar



Porte-outils avec arrosage multiple

Halter mit mehrfaches Kühlungssystem

Tool holders with multiple coolant system

BHS

Système de serrage à vis transversale

Querverschraubungssystem

Clamping system with transverse screw

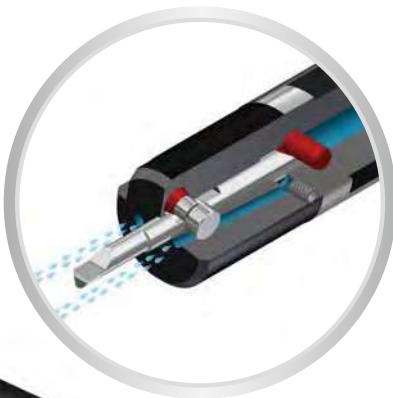

Arrosage sur l'arête de coupe

Kühlung auf der Schneidkante

Cooling on the cutting edge



BF

Arrosage favorisant l'évacuation des copeaux

Spanabfuhr fördernde Kühlung

Cooling for better chip outflow



BF

Arrosage par le centre de l'outil

Zentrale Kühlmittelzufuhr

Cooling through the center of the tool



BB

## IN-LINE

Porte-outils à serrage hydraulique  
Halter mit Hydro-Dehnspann-System  
Tool holders with hydraulic clamping system

BHY



Excellente absorption des vibrations!  
Ausgezeichnete Schwingungsdämpfung!  
Excellent vibration absorbtion!

Arrosage par la barre d'alésage  
Kühlung durch die Bohrstange  
Cooling through the boring bar

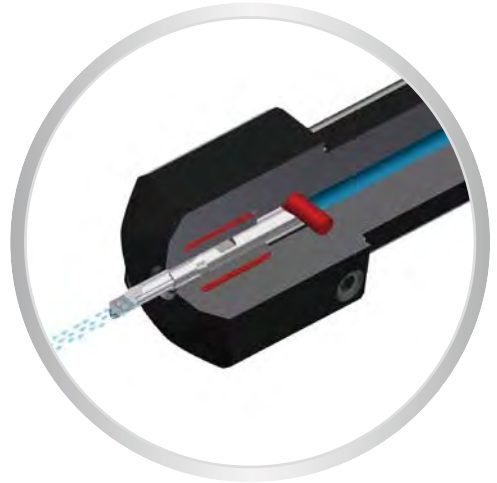

Porte-outils coudés  
Gekröpfte Halter  
Cranked tool holders

BHK

Système de serrage à vis transversale  
Querverschraubungssystem  
Clamping system with transverse screw

Arrosage par la barre d'alésage  
Kühlung durch die Bohrstange  
Cooling through the boring bar

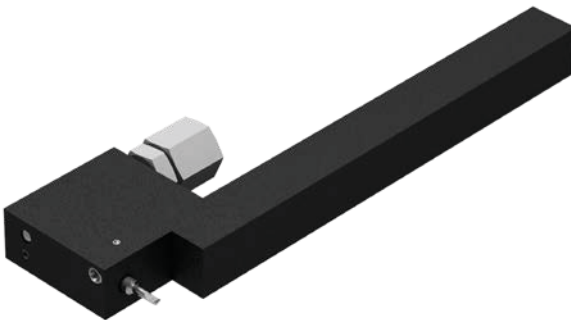

Accessoires de serrage

Spannzubehöre

Clamping accessories

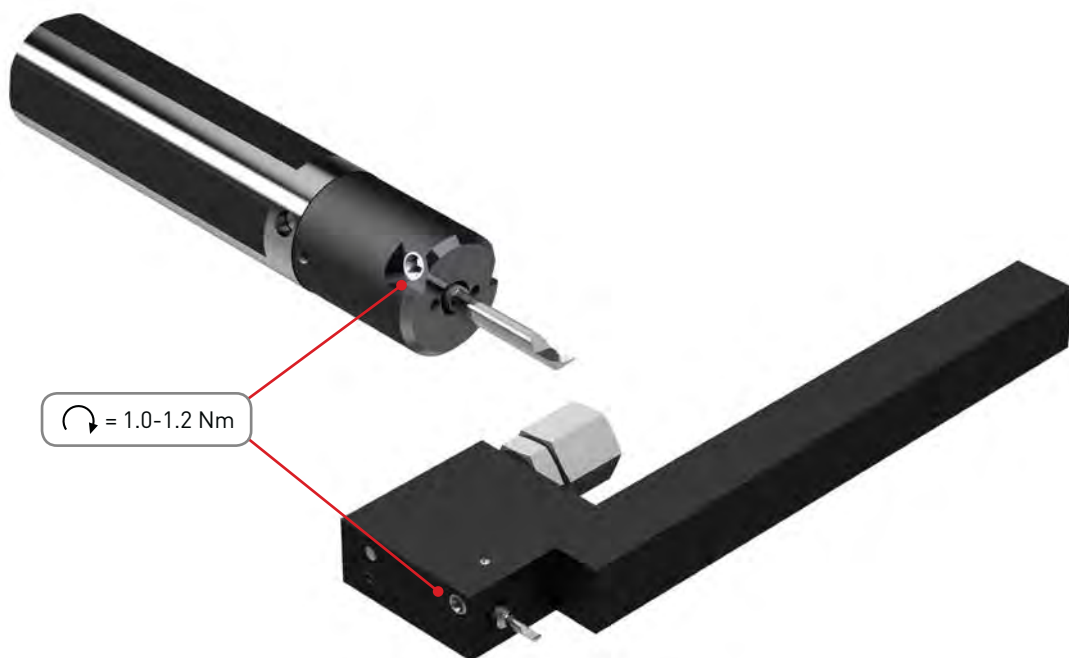

Nous recommandons le serrage des porte-outils types BHS et BHK avec ce type de tournevis dynamométrique.

Wir empfehlen für das Anziehen der Halter Typ BHS und BHK diese Art von Drehmomentschraubendreher.

For holders type BHS and BHK clamping, we recommend this kind of torque screwdriver.



Art. N°

SET-NM1.2-TX8



## ZTAF

ZN + revêtement PVD  
ZN + PVD Beschichtung  
ZN + PVD coating

- nuance universelle pour l'usinage des aciers, aciers inoxydables, aciers alliés, alliage de titane
- bonne résistance à la température

- Universalsorte für die Bearbeitung von Stahl, rostfreiem Stahl, Stahllegierung, Titanlegierung
- gute Warmfestigkeit

- universal grade for steel, stainless steel, alloyed steel, titanium alloys
- good heat resistance

## ZTAXF

ZN + revêtement PVD  
ZN + PVD Beschichtung  
ZN + PVD coating

- nuance très résistante à l'usure et à la température, recommandée pour l'usinage des matières suivantes: Inox 304, 316L, 317L, 904, Phynox
- aciers alliés contenant: Chrome Nickel, Vanadium, Molybdène, ...

- sehr verschleissfeste und temperaturbeständige Sorte. Für folgende Materialien empfohlen: Inox 304, 316L, 317L, 904, Phynox
- legierter Stahl enthaltend: Chrom-Nickel, Vanadium, Molybdän, ...

- very wear and high temperature resistant grade. Recommended for following material: Inox 304, 316L, 317L, 904, Phynox
- alloy steel containing: Chrome-nickel, Vanadium, Molybdenum, ...

## ZN

non revêtu  
unbeschichtet  
uncoated

- nuance de base micro-grain tenace
- 1<sup>er</sup> choix pour l'usinage des métaux non ferreux

- zähe Basis Feinkornsorte
- beste Wahl für die Bearbeitung von Nichteisenmetalle

- tough base micro-grain grade
- first choice for non-ferrous materials

## Paramètres de coupe

## Schnittwerte

## Machining data

Matière Werkstoff Material	VC (m/min)	Ø barre d'alésage Bohrstange Ø boring bar Ø		
		Ø1.0 - Ø2.0 (mm/U)	Ø2.5 - Ø4.0 (mm/U)	Ø4.5 - Ø5.5 (mm/U)
Acier de décolletage Automatenstahl Free-cutting steel	<b>P</b> 60-100	0.02-0.03	0.02-0.08	0.03-0.10
Acier faiblement allié Leicht legierter Stahl Low alloyed steel	<b>P</b> 50-80	0.01-0.03	0.02-0.05	0.03-0.06
Acier fortement allié Legierter Stahl High alloyed steel	<b>P</b> 40-60	0.01-0.02	0.02-0.04	0.02-0.06
Acier inoxydable Rostfreistahl Stainless steel	<b>M</b> 40-90	0.01-0.03	0.02-0.05	0.03-0.08
Aluminium	<b>N</b> 60-150	0.01-0.03	0.02-0.06	0.03-0.10
Cuivre, laiton, bronze Kupfer, Messing, Bronze Copper, brass, bronze	<b>N</b> 60-150	0.01-0.03	0.02-0.05	0.03-0.08
Titane Titan Titanium	<b>S</b> 30-70	0.01-0.03	0.02-0.05	0.03-0.10

# IN-LINE

Porte-outils avec écrou de serrage

Halter mit Spannmutter

Tool holders with clamping nut

BH4...



> page 10.05

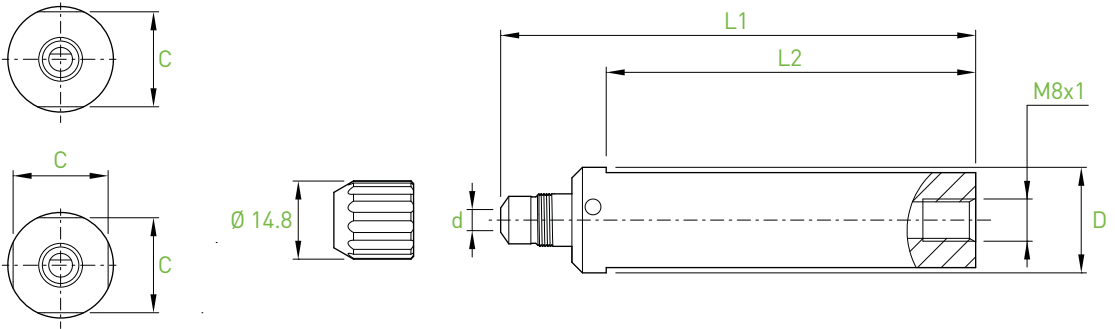

d	Bars	D	L1	L2	C	2 flats	4 flats	Art. N°
4	BB4... BF4...	10	75	55	8.8	■		BH4-D10-75
		12	75	55	11.2	■		BH4-D12-75
		12.7	75	55	11.2	■		BH4-D12.7-75
		15.87	75	55	14	■		BH4-D15.87-75
		16	75	55	14	■		BH4-D16-75
		16	75	55	14		■	BH4-D16-75-F4
		19.05	90	70	17	■		BH4-D19.05-90
		20	90	70	18	■		BH4-D20-90
		20	90	70	18		■	BH4-D20-90-F4
		20	160	140	18		■	BH4-D20-160-F4
		22	90	70	20	■		BH4-D22-90
		22	90	70	20		■	BH4-D22-90-F4
		22	130	110	20		■	BH4-D22-130-F4
		25	100	80	23	■		BH4-D25-100
		25	100	80	23		■	BH4-D25-100-F4
		25	170	150	23		■	BH4-D25-170-F4
25.4	100	80	23.4	■		BH4-D25.4-100		
28	100	80	26	■		BH4-D28-100		

Pièces de rechange  
Ersatzteile  
Spare parts



Art. N°

BH4...

BH4-M10

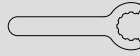

Art. N°

C-BH4-M10

Option

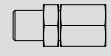

Art. N°

BH4...

J-M8x1-D6

Porte-outils avec écrou de serrage

Halter mit Spannmutter

Tool holders with clamping nut

BH6...



> page 10.05

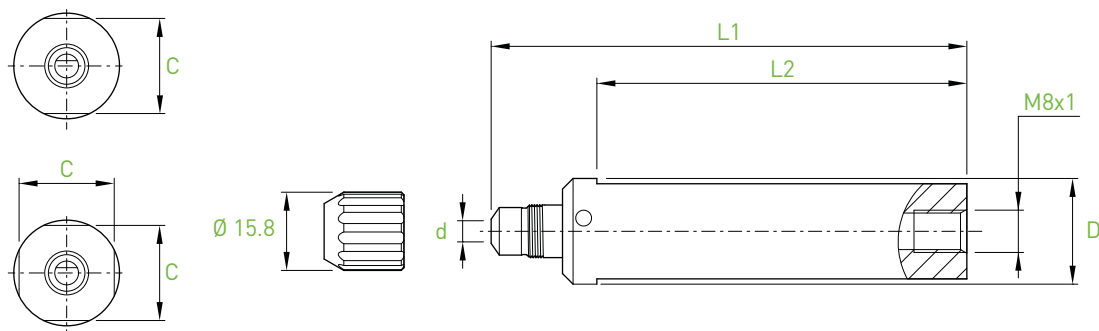

d	Bars	D	L1	L2	C	2 flats	4 flats	Art. N°
6	BH6... BF6...	12	75	55	11.2	■		BH6-D12-75
		12.7	75	55	11.2	■		BH6-D12.7-75
		15.87	75	55	14	■		BH6-D15.87-75
		16	75	55	14	■		BH6-D16-75
		19.05	90	70	17	■		BH6-D19.05-90
		20	90	70	18	■		BH6-D20-90
		20	90	70	18		■	BH6-D20-90-F4
		20	160	140	18		■	BH6-D20-160-F4
		22	90	70	20	■		BH6-D22-90
		22	90	70	20		■	BH6-D22-90-F4
		22	130	110	20		■	BH6-D22-130-F4
		25	100	80	23	■		BH6-D25-100
		25	100	80	23		■	BH6-D25-100-F4
		25	170	150	23		■	BH6-D25-170-F4
		25.4	100	80	23.4	■		BH6-D25.4-100
28	100	80	26	■		BH6-D28-100		

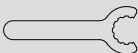
Pièces de rechange Ersatzteile Spare parts	 Art. N°	 Art. N°
BH6...	BH6-M12	C-BH6-M12

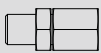
Option	 Art. N°
BH6...	J-M8x1-D6

■ = disponible / verfügbar / available  
□ = selon disponibilité du stock / jenach Lagerverfügbarkeit / depending the stock availability

Porte-outils avec arrosage multiple  
 Halter mit mehrfaches Kühlungssystem  
 Tool holders with multiple coolant system

## BHS4...



> page 10.05/10.07

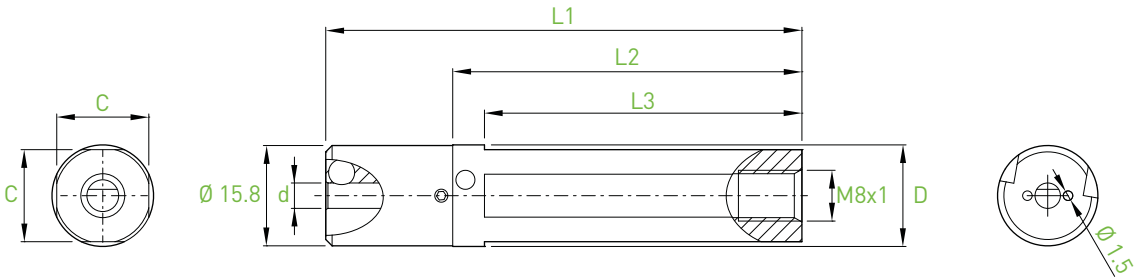

d	Bars	D	L1	L2	L3	C	Art. N°
4	BB4... BF4...	10	75	55	50	9.2	BHS4-D10-75-F4
		12	75	55	50	11	BHS4-D12-75-F4
		12.7	75	55	50	11.7	BHS4-D12.7-75-F4
		15.87	75	55	50	14.5	BHS4-D15.87-75-F4
		16	75	55	50	14.5	BHS4-D16-75-F4
		16	110	90	85	14.5	BHS4-D16-110-F4
		19.05	90	70	65	17	BHS4-D19.05-90-F4
		20	90	70	65	18	BHS4-D20-90-F4
		20	160	140	135	18	BHS4-D20-160-F4
		22	90	70	65	20	BHS4-D22-90-F4
		22	130	110	105	20	BHS4-D22-130-F4
		25	100	80	75	23	BHS4-D25-100-F4
		25	170	150	145	23	BHS4-D25-170-F4
		25.4	100	80	75	23	BHS4-D25.4-100-F4
28	100	80	75	26	BHS4-D28-100-F4		

Pièces de rechange  
 Ersatzteile  
 Spare parts

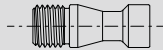

Art. N°

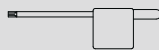

Art. N°

Option

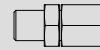

Art. N°

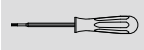

Art. N°

BHS4...

V-BHS-M4x0.5-T8

C-T8

BHS4...

J-M8x1-D6

SET-NM1.2-TX8

Porte-outils avec arrosage multiple  
 Halter mit mehrfaches Kühlungssystem  
 Tool holders with multiple coolant system

BHS6...



> page 10.05/10.07

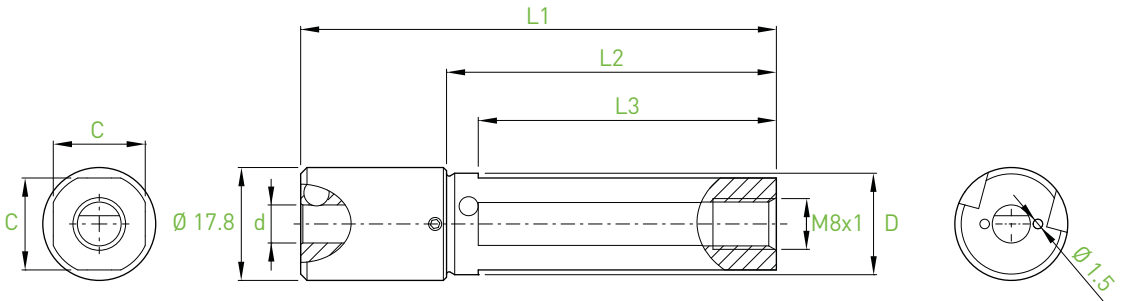

d	Bars	D	L1	L2	L3	C	Art. N°
6	BB6... BF6...	12	75	52	47	11	BHS6-D12-75-F4
		12.7	75	52	47	11.7	BHS6-D12.7-75-F4
		15.87	75	52	47	14.5	BHS6-D15.87-75-F4
		16	75	52	47	14.5	BHS6-D16-75-F4
		16	110	87	82	14.5	BHS6-D16-110-F4
		19.05	90	67	62	17	BHS6-D19.05-90-F4
		20	90	67	62	18	BHS6-D20-90-F4
		20	160	137	132	18	BHS6-D20-160-F4
		22	90	67	62	20	BHS6-D22-90-F4
		22	130	107	102	20	BHS6-D22-130-F4
		25	100	77	72	23	BHS6-D25-100-F4
		25	170	147	142	23	BHS6-D25-170-F4
		25.4	100	77	72	23	BHS6-D25.4-100-F4
28	100	77	72	26	BHS6-D28-100-F4		

Pièces de rechange  
 Ersatzteile  
 Spare parts

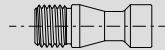

Art. N°

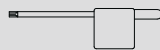

Art. N°

BHS6...

V-BHS-M4x0.5-T8

C-T8

Option

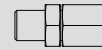

Art. N°

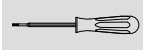

Art. N°

BHS6...

J-M8x1-D6

SET-NM1.2-TX8

Porte-outils à serrage hydraulique  
 Halter mit Hydro-Dehnspann-System  
 Tool holders with hydraulic clamping system

**BHY4...**

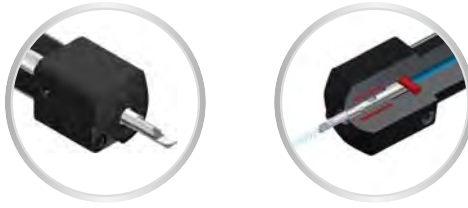

> page 10.06

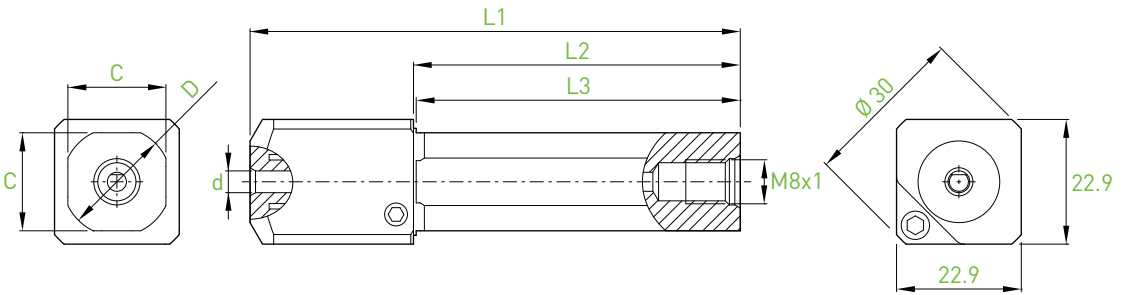

d	Bars	D	L1	L2	L3	C	Art. N°
4	BB4... BF4...	12	90	60	59.5	11.2	<b>BHY4-D12-90-F4</b>
		16	90	60	59.5	14.5	<b>BHY4-D16-90-F4</b>
		19.05	90	60	59.5	17	<b>BHY4-D19.05-90-F4</b>
		20	90	60	59.5	18	<b>BHY4-D20-90-F4</b>
		22	90	60	59.5	20	<b>BHY4-D22-90-F4</b>
		25	100	70	70	23	<b>BHY4-D25-100-F4</b>

Pièces de rechange  
 Ersatzteile  
 Spare parts

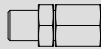

Art. N°

BHY4...

**J-M8x1-D6**

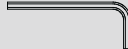

Art. N°

**C-6P-3.0**

Porte-outils à serrage hydraulique  
 Halter mit Hydro-Dehnspann-System  
 Tool holders with hydraulic clamping system

BHY6...



&gt; page 10.06

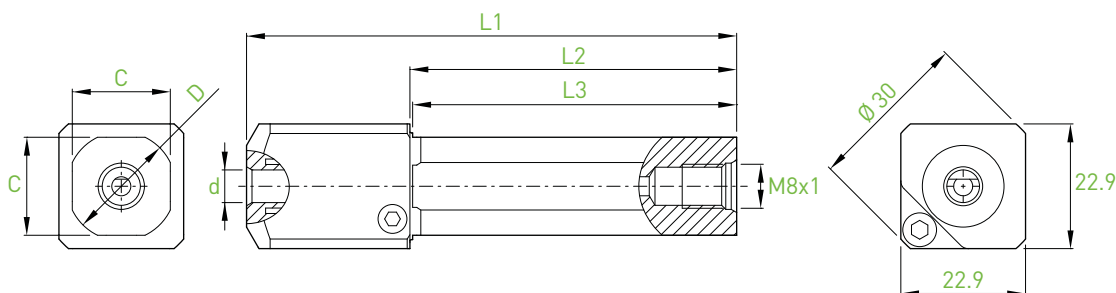

d	Bars	D	L1	L2	L3	C	Art. N°
6	BB6... BF6...	12	90	60	59.5	11.2	BHY6-D12-90-F4
		16	90	60	59.5	14.5	BHY6-D16-90-F4
		19.05	90	60	59.5	17	BHY6-D19.05-90-F4
		20	90	60	59.5	18	BHY6-D20-90-F4
		22	90	60	59.5	20	BHY6-D22-90-F4
		25	100	70	70	23	BHY6-D25-100-F4

Pièces de rechange  
 Ersatzteile  
 Spare parts



Art. N°

BHY6...

J-M8x1-D6



Art. N°



C-6P-3.0

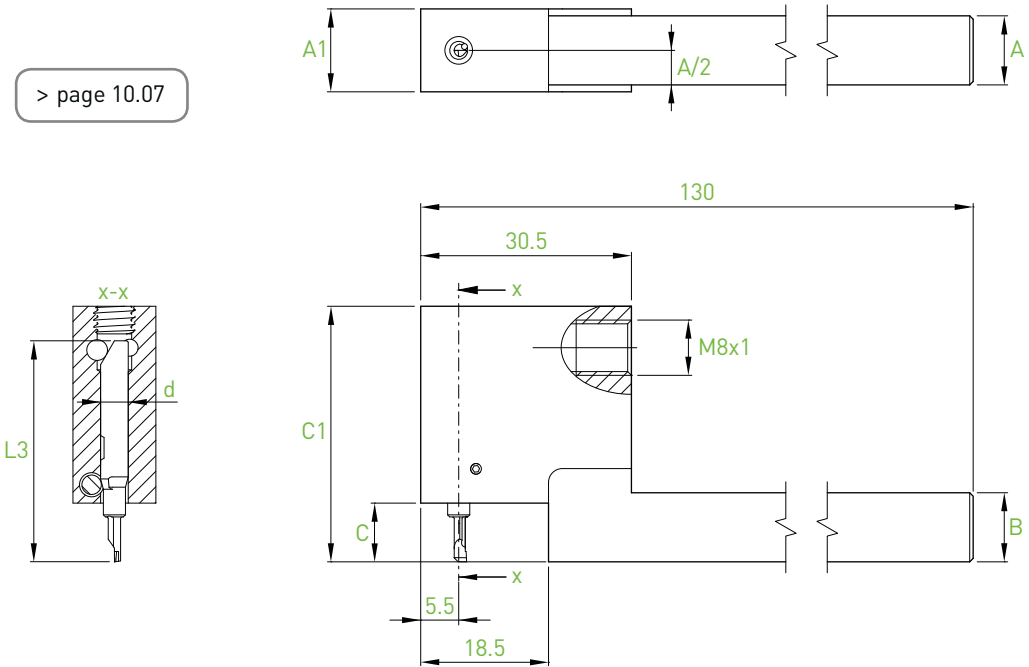

> page 10.07

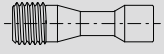

d	Compatible bars L3	A	B	C	C1	A1	Art. N°
4	32	8	8	8.5	37	12	BHK4N-0808X-32R
		10	10	8.5	37	12	BHK4N-1010X-32R
		12	12	8.5	37	12	BHK4N-1212X-32R
		16	16	8.5	37	16	BHK4N-1616X-32R
	37	8	8	13.5	42	12	BHK4N-0808X-37R
		10	10	13.5	42	12	BHK4N-1010X-37R
		12	12	13.5	42	12	BHK4N-1212X-37R
		16	16	13.5	42	16	BHK4N-1616X-37R
	42	10	10	18.5	47	12	BHK4N-1010X-42R
		12	12	18.5	47	12	BHK4N-1212X-42R
		16	16	18.5	47	16	BHK4N-1616X-42R

Pièces de rechange Ersatzteile Spare parts		
	Art. N°	Art. N°
BHK4N...	V-BHK-M4x0.5-T8	C-T8

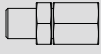
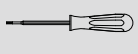
Option		
	Art. N°	Art. N°
BHK4N...	J-M8x1-D6	SET-NM1.2-TX8

Porte-outils coudés  
 Kröpfunghalter  
 Cranked tool holders

BHK6N...

> page 10.07

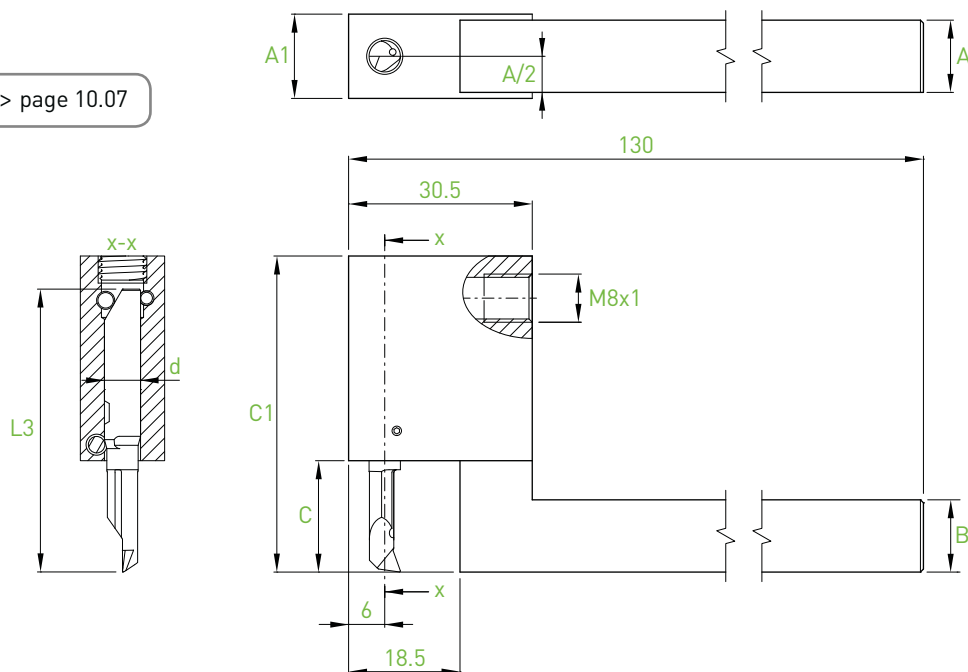

d	Compatible bars L3		A	B	C	C1	A1	Art. N°
6	BB6R...	47	10	10	18.5	52.5	12	BHK6N-1010X-47R
			12	12	18.5	52.5	12	BHK6N-1212X-47R
			16	16	18.5	52.5	16	BHK6N-1616X-47R
	BF6R...	57	10	10	28.5	62.5	12	BHK6N-1010X-57R
			12	12	28.5	62.5	12	BHK6N-1212X-57R
			16	16	28.5	62.5	16	BHK6N-1616X-57R

Pièces de rechange Ersatzteile Spare parts		
	Art. N°	Art. N°
BHK6N...	V-BHK-M4x0.5-T8	C-T8

Option		
	Art. N°	Art. N°
BHK6N...	J-M8x1-D6	SET-NM1.2-TX8

# IN-LINE

Alésage  
Ausbohren  
Boring



BB4...

BA

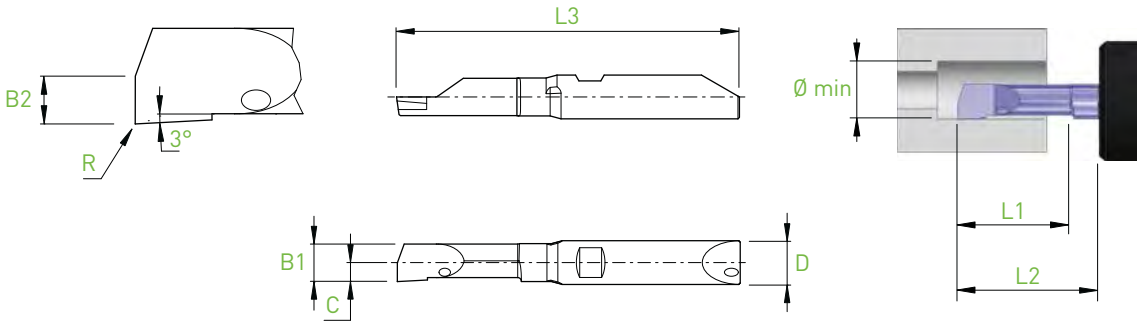

D h5	Holder	Ø min	L1	L2 BH4... BHY4...	L2 BHS4... BHK4...	B1	B2	C	R	L3	Art. N°	R		L		
												ZTAF	ZTAXF	ZN	ZTAF	ZN
4	BH4... BHS4... BHY4... BHK4...	0.3	0.9	10	8.5	0.27	0.13	0.15	0	32	BB4R/L-0309-BA	■	■	■	□	□
		0.4	1.2	10	8.5	0.36	0.18	0.20	0	32	BB4R/L-0412-BA	■	■	■	□	□
		0.5	1.5	10	8.5	0.45	0.22	0.25	0	32	BB4R/L-0515-BA	■	■	■	□	□
		1.0	3.0	10	8.5	0.90	0.45	0.60	0.02	32	BB4R/L-1030-BA-R02	■	■	■	□	□
		1.5	4.5	10	8.5	1.35	0.67	0.65	0.02	32	BB4R/L-1545-BA-R02	■	■	■	□	□
		2.0	6.0	10	8.5	1.80	0.90	1.15	0.02	32	BB4R/L-2060-BA-R02	■	■	■	□	□
		2.5	7.5	10	8.5	2.25	1.13	1.30	0.02	32	BB4R/L-2575-BA-R02	■	■	■	□	□
		3.0	9.0	15	13.5	2.70	1.35	1.35	0.05	37	BB4R/L-3090-BA-R05	■	■	■	□	□
3.5	10.5	15	13.5	3.15	1.58	1.60	0.05	37	BB4R/L-35105-BA-R05	■	■	■	□	□		

Alésage

Ausbohren

Boring



BF4...

BA

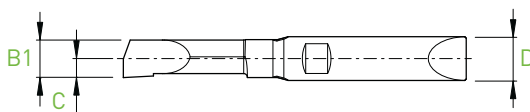
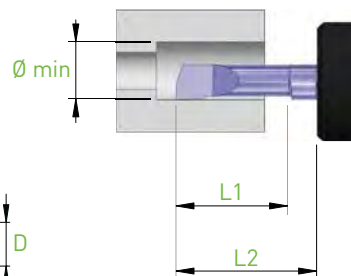
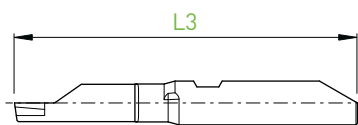
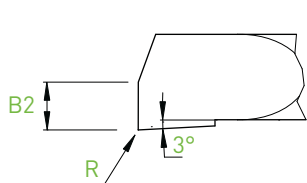

D h5	Holder	Ø min	L1	L2 BH4... BHY4...	L2 BHS4... BHK4...	B1	B2	C	R	L3	Art. N°	R		L		
												ZTAF	ZTAXF	ZN	ZTAF	ZN
4	BH4... BHS4... BHY4... BHK4...	0.3	0.9	10	8.5	0.27	0.13	0.15	0	32	BF4R/L-0309-BA	■	■	■	□	□
		0.4	1.2	10	8.5	0.36	0.18	0.20	0	32	BF4R/L-0412-BA	■	■	■	□	□
		0.5	1.5	10	8.5	0.45	0.22	0.25	0	32	BF4R/L-0515-BA	■	■	■	□	□
		1.0	3.0	10	8.5	0.90	0.45	0.60	0.02	32	BF4R/L-1030-BA-R02	■	■	■	□	□
		1.5	4.5	10	8.5	1.35	0.67	0.65	0.02	32	BF4R/L-1545-BA-R02	■	■	■	□	□
		2.0	6.0	10	8.5	1.80	0.90	1.15	0.02	32	BF4R/L-2060-BA-R02	■	■	■	□	□
		2.5	7.5	10	8.5	2.25	1.13	1.30	0.02	32	BF4R/L-2575-BA-R02	■	■	■	□	□
		3.0	9.0	15	13.5	2.70	1.35	1.35	0.05	37	BF4R/L-3090-BA-R05	■	■	■	□	□
		3.5	10.5	15	13.5	3.15	1.58	1.60	0.05	37	BF4R/L-35105-BA-R05	■	■	■	□	□

Alésage  
Ausbohren  
Boring



## BB4... / BB6...

## BAX

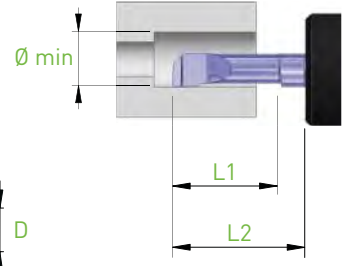
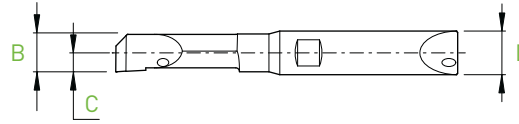
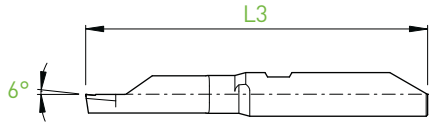
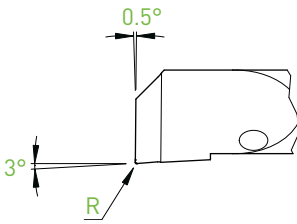

D h5	Holder	Ø min	L1	L2		B	C	R	L3	Art. N°	R		L		
				BH4... BHY4...	BHS4... BHK4...						ZTAF	ZTAXF	ZN	ZTAF	ZN
4	BH4... BHS4... BHY4... BHK4...	0.5	1.5	10	8.5	0.45	0.25	0	32	BB4R/L-0515-BAX	■	■	■	□	□
		0.6	1.8	10	8.5	0.54	0.30	0	32	BB4R/L-0618-BAX	■	■	■	□	□
		0.7	2.1	10	8.5	0.63	0.35	0	32	BB4R/L-0721-BAX	■	■	■	□	□
		0.8	2.4	10	8.5	0.72	0.40	0	32	BB4R/L-0824-BAX	■	■	■	□	□
		0.9	2.7	10	8.5	0.81	0.45	0	32	BB4R/L-0927-BAX	■	■	■	□	□
		1.0	3.0	10	8.5	0.90	0.60	0.02	32	BB4R/L-1030-BAX-R02	■	■	■	□	□
			5.0	10	8.5	0.90	0.60	0.02	32	BB4R/L-1050-BAX-R02	■	■	■	□	□
		1.5	4.5	10	8.5	1.35	0.65	0.02	32	BB4R/L-1545-BAX-R02	■	■	■	□	□
			7.5	10	8.5	1.35	0.65	0.02	32	BB4R/L-1575-BAX-R02	■	■	■	□	□
		2.0	6.0	10	8.5	1.80	1.15	0.02	32	BB4R/L-2060-BAX-R02	■	■	■	□	□
			10.0	15	13.5	1.80	1.15	0.02	37	BB4R/L-20100-BAX-R02	■	■	■	□	□
		2.5	7.5	10	8.5	2.25	1.30	0.05	32	BB4R/L-2575-BAX-R05	■	■	■	□	□
			12.5	15	13.5	2.25	1.30	0.05	37	BB4R/L-25125-BAX-R05	■	■	■	□	□
		3.0	9.0	15	13.5	2.70	1.35	0.05	37	BB4R/L-3090-BAX-R05	■	■	■	□	□
15.0	20		18.5	2.70	1.35	0.05	42	BB4R/L-30150-BAX-R05	■	■	■	□	□		
3.5	10.5	15	13.5	3.15	1.60	0.05	37	BB4R/L-35105-BAX-R05	■	■	■	□	□		
	17.5	20	18.5	3.15	1.60	0.05	42	BB4R/L-35175-BAX-R05	■	■	■	□	□		

D h5	Holder	Ø min	L1	L2		B	C	R	L3	Art. N°	R		L		
				BH6... BHY6...	BHS6... BHK6...						ZTAF	ZTAXF	ZN	ZTAF	ZN
6	BH6... BHS6... BHY6... BHK6...	4.0	12.0	20	18.5	3.80	2.20	0.05	47	BB6R/L-40120-BAX-R05	■	■	■	□	□
			20.0	30	28.5	3.80	2.20	0.05	57	BB6R/L-40200-BAX-R05	■	■	■	□	□
		4.5	13.5	20	18.5	4.28	2.30	0.05	47	BB6R/L-45135-BAX-R05	■	■	■	□	□
			22.5	30	28.5	4.28	2.30	0.05	57	BB6R/L-45225-BAX-R05	■	■	■	□	□
		5.0	15.0	20	18.5	4.75	2.40	0.05	47	BB6R/L-50150-BAX-R05	■	■	■	□	□
			25.0	30	28.5	4.75	2.40	0.05	57	BB6R/L-50250-BAX-R05	■	■	■	□	□
		5.5	16.5	20	18.5	5.15	2.60	0.05	47	BB6R/L-55165-BAX-R05	■	■	■	□	□
			27.5	30	28.5	5.15	2.60	0.05	57	BB6R/L-55275-BAX-R05	■	■	■	□	□

Alésage  
Ausbohren  
Boring



BF4... / BF6...

BAX

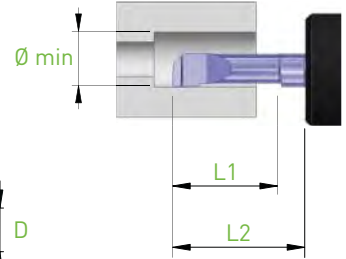
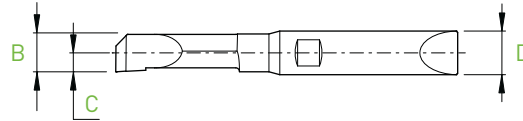
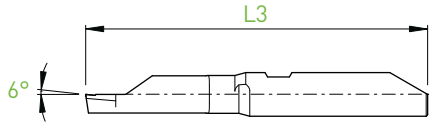
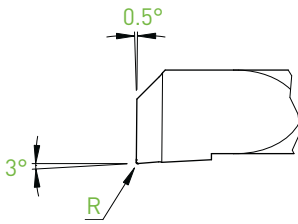

D h5	Holder	Ø min	L1	L2		B	C	R	L3	Art. N°	R		L		
				BH4... BHY4...	BHS4... BHK4...						ZTAF	ZTAXF	ZN	ZTAF	ZN
4	BH4... BHS4... BHY4... BHK4...	0.5	1.5	10	8.5	0.45	0.25	0	32	BF4R/L-0515-BAX	■	■	■	□	□
		0.6	1.8	10	8.5	0.54	0.30	0	32	BF4R/L-0618-BAX	■	■	■	□	□
		0.7	2.1	10	8.5	0.63	0.35	0	32	BF4R/L-0721-BAX	■	■	■	□	□
		0.8	2.4	10	8.5	0.72	0.40	0	32	BF4R/L-0824-BAX	■	■	■	□	□
		0.9	2.7	10	8.5	0.81	0.45	0	32	BF4R/L-0927-BAX	■	■	■	□	□
		1.0	3.0	10	8.5	0.90	0.60	0.02	32	BF4R/L-1030-BAX-R02	■	■	■	□	□
			5.0	10	8.5	0.90	0.60	0.02	32	BF4R/L-1050-BAX-R02	■	■	■	□	□
		1.5	4.5	10	8.5	1.35	0.65	0.02	32	BF4R/L-1545-BAX-R02	■	■	■	□	□
			7.5	10	8.5	1.35	0.65	0.02	32	BF4R/L-1575-BAX-R02	■	■	■	□	□
		2.0	6.0	10	8.5	1.80	1.15	0.02	32	BF4R/L-2060-BAX-R02	■	■	■	□	□
			10.0	15	13.5	1.80	1.15	0.02	37	BF4R/L-20100-BAX-R02	■	■	■	□	□
		2.5	7.5	10	8.5	2.25	1.30	0.05	32	BF4R/L-2575-BAX-R05	■	■	■	□	□
			12.5	15	13.5	2.25	1.30	0.05	37	BF4R/L-25125-BAX-R05	■	■	■	□	□
		3.0	9.0	15	13.5	2.70	1.35	0.05	37	BF4R/L-3090-BAX-R05	■	■	■	□	□
15.0	20		18.5	2.70	1.35	0.05	42	BF4R/L-30150-BAX-R05	■	■	■	□	□		
3.5	10.5	15	13.5	3.15	1.60	0.05	37	BF4R/L-35105-BAX-R05	■	■	■	□	□		
	17.5	20	18.5	3.15	1.60	0.05	42	BF4R/L-35175-BAX-R05	■	■	■	□	□		

D h5	Holder	Ø min	L1	L2		B	C	R	L3	Art. N°	R		L		
				BH6... BHY6...	BHS6... BHK6...						ZTAF	ZTAXF	ZN	ZTAF	ZN
6	BH6... BHS6... BHY6... BHK6...	4.0	12.0	20	18.5	3.80	2.20	0.05	47	BF6R/L-40120-BAX-R05	■	■	■	□	□
			20.0	30	28.5	3.80	2.20	0.05	57	BF6R/L-40200-BAX-R05	■	■	■	□	□
		4.5	13.5	20	18.5	4.28	2.30	0.05	47	BF6R/L-45135-BAX-R05	■	■	■	□	□
			22.5	30	28.5	4.28	2.30	0.05	57	BF6R/L-45225-BAX-R05	■	■	■	□	□
		5.0	15.0	20	18.5	4.75	2.40	0.05	47	BF6R/L-50150-BAX-R05	■	■	■	□	□
			25.0	30	28.5	4.75	2.40	0.05	57	BF6R/L-50250-BAX-R05	■	■	■	□	□
		5.5	16.5	20	18.5	5.15	2.60	0.05	47	BF6R/L-55165-BAX-R05	■	■	■	□	□
			27.5	30	28.5	5.15	2.60	0.05	57	BF6R/L-55275-BAX-R05	■	■	■	□	□

■ = disponible / verfügbar / available  
□ = selon disponibilité du stock / jenach Lagerverfügbarkeit / depending the stock availability

# IN-LINE

- Alésage-copiage
- Ausbohren-kopieren
- Boring chambering



**BB4... / BB6...**

**BCX**

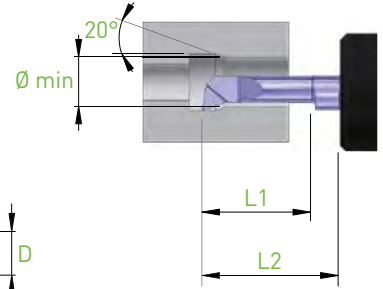
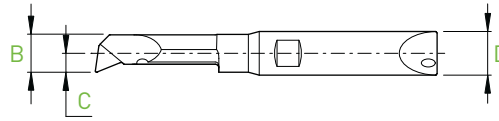
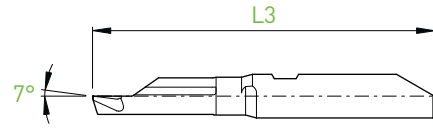
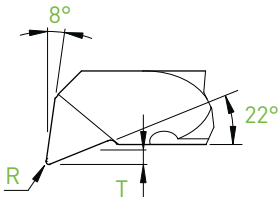

D <sub>h5</sub>	Holder	Ø min	L1	L2 BH4... BHY4...	L2 BHS4... BHK4...	T	B	C	R	L3	Art. N°	R		L		
												ZTAF	ZTAXF	ZN	ZTAF	ZN
4	BH4... BHS4... BHY4... BHK4...	1.0	3.0	10	8.5	0.15	0.90	0.70	0.05	32	<b>BB4R/L-1030-BCX-R05</b>	■	■	■	□	□
			5.0	10	8.5	0.15	0.90	0.70	0.05	32	<b>BB4R/L-1050-BCX-R05</b>	■	■	■	□	□
		1.5	4.5	10	8.5	0.23	1.35	0.75	0.05	32	<b>BB4R/L-1545-BCX-R05</b>	■	■	■	□	□
			7.5	10	8.5	0.23	1.35	0.75	0.05	32	<b>BB4R/L-1575-BCX-R05</b>	■	■	■	□	□
		2.0	6.0	10	8.5	0.30	1.80	1.15	0.05	32	<b>BB4R/L-2060-BCX-R05</b>	■	■	■	□	□
			10.0	15	13.5	0.30	1.80	1.15	0.05	37	<b>BB4R/L-20100-BCX-R05</b>	■	■	■	□	□
		2.5	7.5	10	8.5	0.38	2.25	1.30	0.10	32	<b>BB4R/L-2575-BCX-R10</b>	■	■	■	□	□
			12.5	15	13.5	0.38	2.25	1.30	0.10	37	<b>BB4R/L-25125-BCX-R10</b>	■	■	■	□	□
		3.0	9.0	15	13.5	0.45	2.70	1.35	0.10	37	<b>BB4R/L-3090-BCX-R10</b>	■	■	■	□	□
			15.0	20	18.5	0.45	2.70	1.35	0.10	42	<b>BB4R/L-30150-BCX-R10</b>	■	■	■	□	□
		3.5	10.5	15	13.5	0.53	3.15	1.60	0.10	37	<b>BB4R/L-35105-BCX-R10</b>	■	■	■	□	□
			17.5	20	18.5	0.53	3.15	1.60	0.10	42	<b>BB4R/L-35175-BCX-R10</b>	■	■	■	□	□

D <sub>h5</sub>	Holder	Ø min	L1	L2 BH6... BHY6...	L2 BHS6... BHK6...	T	B	C	R	L3	Art. N°	R		L		
												ZTAF	ZTAXF	ZN	ZTAF	ZN
6	BH6... BHS6... BHY6... BHK6...	4.0	12.0	20	18.5	0.60	3.80	2.20	0.15	47	<b>BB6R/L-40120-BCX-R15</b>	■	■	■	□	□
			20.0	30	28.5	0.60	3.80	2.20	0.15	57	<b>BB6R/L-40200-BCX-R15</b>	■	■	■	□	□
		4.5	13.5	20	18.5	0.68	4.28	2.30	0.15	47	<b>BB6R/L-45135-BCX-R15</b>	■	■	■	□	□
			22.5	30	28.5	0.68	4.28	2.30	0.15	57	<b>BB6R/L-45225-BCX-R15</b>	■	■	■	□	□
		5.0	15.0	20	18.5	0.75	4.75	2.40	0.15	47	<b>BB6R/L-50150-BCX-R15</b>	■	■	■	□	□
			25.0	30	28.5	0.75	4.75	2.40	0.15	57	<b>BB6R/L-50250-BCX-R15</b>	■	■	■	□	□
		5.5	16.5	20	18.5	0.83	5.15	2.60	0.15	47	<b>BB6R/L-55165-BCX-R15</b>	■	■	■	□	□
			27.5	30	28.5	0.83	5.15	2.60	0.15	57	<b>BB6R/L-55275-BCX-R15</b>	■	■	■	□	□

Alésage-copiage  
 Ausbohren-kopieren  
 Boring chambering

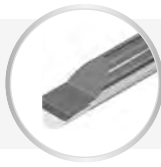

BF4... / BF6...

BCX

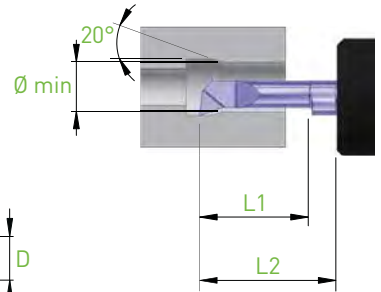
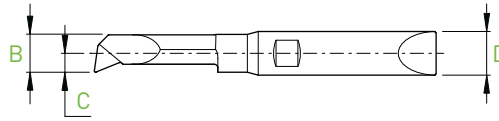
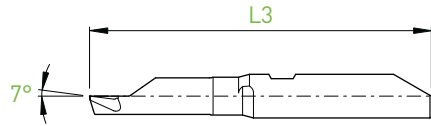
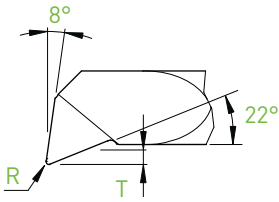

D <sub>h5</sub>	Holder	Ø min	L1	L2 BH4... BHY4...	L2 BHS4... BHK4...	T	B	C	R	L3	Art. N°	R		L		
												ZTAF	ZTAXF	ZN	ZTAF	ZN
4	BH4... BHS4... BHY4... BHK4...	1.0	3.0	10	8.5	0.15	0.90	0.70	0.05	32	BF4R/L-1030-BCX-R05	■	■	■	□	□
			5.0	10	8.5	0.15	0.90	0.70	0.05	32	BF4R/L-1050-BCX-R05	■	■	■	□	□
		1.5	4.5	10	8.5	0.23	1.35	0.75	0.05	32	BF4R/L-1545-BCX-R05	■	■	■	□	□
			7.5	10	8.5	0.23	1.35	0.75	0.05	32	BF4R/L-1575-BCX-R05	■	■	■	□	□
		2.0	6.0	10	8.5	0.30	1.80	1.15	0.05	32	BF4R/L-2060-BCX-R05	■	■	■	□	□
			10.0	15	13.5	0.30	1.80	1.15	0.05	37	BF4R/L-20100-BCX-R05	■	■	■	□	□
		2.5	7.5	10	8.5	0.38	2.25	1.30	0.10	32	BF4R/L-2575-BCX-R10	■	■	■	□	□
			12.5	15	13.5	0.38	2.25	1.30	0.10	37	BF4R/L-25125-BCX-R10	■	■	■	□	□
		3.0	9.0	15	13.5	0.45	2.70	1.35	0.10	37	BF4R/L-3090-BCX-R10	■	■	■	□	□
			15.0	20	18.5	0.45	2.70	1.35	0.10	42	BF4R/L-30150-BCX-R10	■	■	■	□	□
		3.5	10.5	15	13.5	0.53	3.15	1.60	0.10	37	BF4R/L-35105-BCX-R10	■	■	■	□	□
			17.5	20	18.5	0.53	3.15	1.60	0.10	42	BF4R/L-35175-BCX-R10	■	■	■	□	□

D <sub>h5</sub>	Holder	Ø min	L1	L2 BH6... BHY6...	L2 BHS6... BHK6...	T	B	C	R	L3	Art. N°	R		L		
												ZTAF	ZTAXF	ZN	ZTAF	ZN
6	BH6... BHS6... BHY6... BHK6...	4.0	12.0	20	18.5	0.60	3.80	2.20	0.15	47	BF6R/L-40120-BCX-R15	■	■	■	□	□
			20.0	30	28.5	0.60	3.80	2.20	0.15	57	BF6R/L-40200-BCX-R15	■	■	■	□	□
		4.5	13.5	20	18.5	0.68	4.28	2.30	0.15	47	BF6R/L-45135-BCX-R15	■	■	■	□	□
			22.5	30	28.5	0.68	4.28	2.30	0.15	57	BF6R/L-45225-BCX-R15	■	■	■	□	□
		5.0	15.0	20	18.5	0.75	4.75	2.40	0.15	47	BF6R/L-50150-BCX-R15	■	■	■	□	□
			25.0	30	28.5	0.75	4.75	2.40	0.15	57	BF6R/L-50250-BCX-R15	■	■	■	□	□
		5.5	16.5	20	18.5	0.83	5.15	2.60	0.15	47	BF6R/L-55165-BCX-R15	■	■	■	□	□
			27.5	30	28.5	0.83	5.15	2.60	0.15	57	BF6R/L-55275-BCX-R15	■	■	■	□	□

■ = disponible / verfügbar / available  
 □ = selon disponibilité du stock / jenach Lagerverfügbarkeit / depending the stock availability



- Copiage**
- Kopieren**
- Chambering**



## BB4... / BB6...

## C45

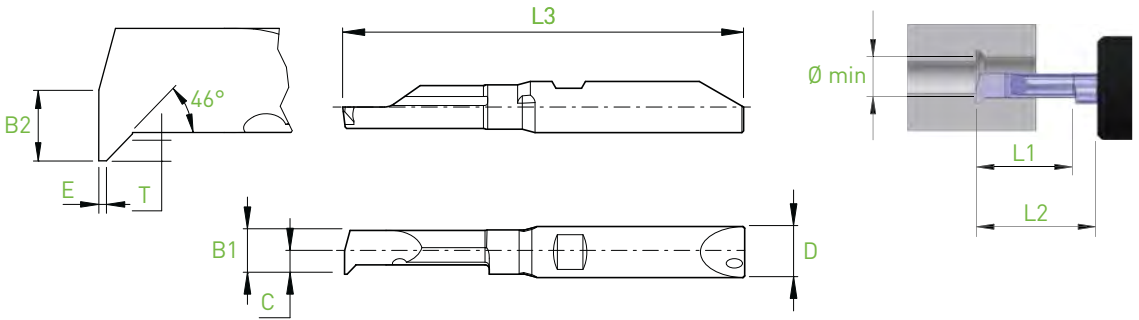

D h5	Holder	Ø min	L1	L2 BH4... BHY4...	L2 BHS4... BHK4...	T	B1	B2	C	E	L3	Art. N°	R		L		
													ZTAF	ZTAXF	ZN	ZTAF	ZN
4	BH4... BHS4... BHY4... BHK4...	0.3	0.6	10	8.5	0.05	0.27	0.13	0.15	0.03	32	<b>BB4R/L-0306-C45-E03</b>	■	■	■	□	□
		0.4	0.8	10	8.5	0.07	0.36	0.18	0.20	0.03	32	<b>BB4R/L-0408-C45-E03</b>	■	■	■	□	□
		0.5	1.0	10	8.5	0.08	0.45	0.22	0.25	0.03	32	<b>BB4R/L-0510-C45-E03</b>	■	■	■	□	□
		0.6	1.2	10	8.5	0.10	0.54	0.27	0.30	0.03	32	<b>BB4R/L-0612-C45-E03</b>	■	■	■	□	□
		0.7	1.2	10	8.5	0.12	0.63	0.32	0.35	0.03	32	<b>BB4R/L-0714-C45-E03</b>	■	■	■	□	□
		0.8	1.6	10	8.5	0.14	0.72	0.36	0.40	0.05	32	<b>BB4R/L-0816-C45-E05</b>	■	■	■	□	□
		0.9	1.8	10	8.5	0.15	0.81	0.41	0.45	0.05	32	<b>BB4R/L-0918-C45-E05</b>	■	■	■	□	□
		1.0	3.0	10	8.5	0.17	0.90	0.45	0.70	0.10	32	<b>BB4R/L-1030-C45-E10</b>	■	■	■	□	□
		1.5	4.5	10	8.5	0.25	1.35	0.67	0.75	0.10	32	<b>BB4R/L-1545-C45-E10</b>	■	■	■	□	□
		2.0	6.0	10	8.5	0.34	1.80	0.90	1.15	0.20	32	<b>BB4R/L-2060-C45-E20</b>	■	■	■	□	□
		2.5	7.5	10	8.5	0.43	2.25	1.13	1.30	0.20	32	<b>BB4R/L-2575-C45-E20</b>	■	■	■	□	□
3.0	9.0	15	13.5	0.51	2.70	1.35	1.35	0.30	37	<b>BB4R/L-3090-C45-E30</b>	■	■	■	□	□		
3.5	10.5	15	13.5	0.60	3.15	1.58	1.60	0.30	37	<b>BB4R/L-35105-C45-E30</b>	■	■	■	□	□		
D h5	Holder	Ø min	L1	L2 BH6... BHY6...	L2 BHS6... BHK6...	T	B1	B2	C	E	L3	Art. N°	ZTAF	ZTAXF	ZN	ZTAF	ZN
6	BH6... BHS6... BHY6... BHK6...	4.0	12.0	20	18.5	0.68	3.80	1.90	2.30	0.40	47	<b>BB6R/L-40120-C45-E40</b>	■	■	■	□	□
		5.0	15.0	20	18.5	0.85	4.75	2.37	2.50	0.50	47	<b>BB6R/L-50150-C45-E50</b>	■	■	■	□	□

Copiage  
Kopieren  
Chamfering

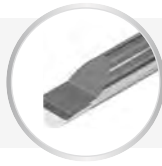

BF4... / BF6...

C45

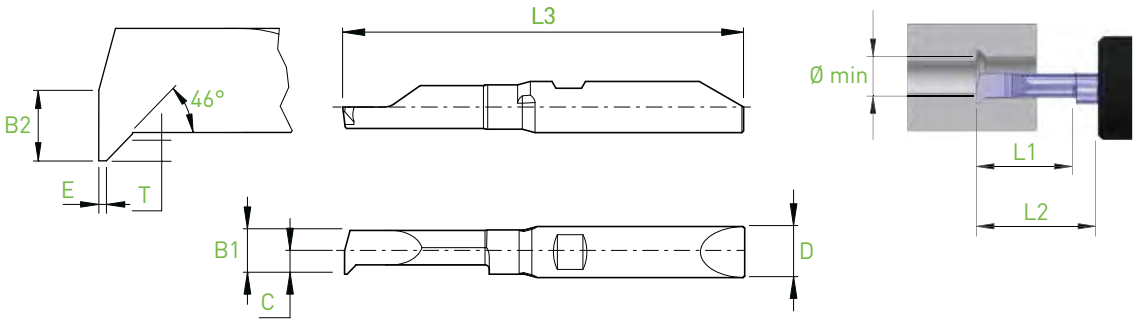

D h5	Holder	Ø min	L1	L2 BH4... BHY4...	L2 BHS4... BHK4...	T	B1	B2	C	E	L3	Art. N°	R		L		
													ZTAF	ZTAXF	ZN	ZTAF	ZN
4	BH4... BHS4... BHY4... BHK4...	0.3	0.6	10	8.5	0.05	0.27	0.13	0.15	0.03	32	BF4R/L-0306-C45-E03	■	■	■	□	□
		0.4	0.8	10	8.5	0.07	0.36	0.18	0.20	0.03	32	BF4R/L-0408-C45-E03	■	■	■	□	□
		0.5	1.0	10	8.5	0.08	0.45	0.22	0.25	0.03	32	BF4R/L-0510-C45-E03	■	■	■	□	□
		0.6	1.2	10	8.5	0.10	0.54	0.27	0.30	0.03	32	BF4R/L-0612-C45-E03	■	■	■	□	□
		0.7	1.2	10	8.5	0.12	0.63	0.32	0.35	0.03	32	BF4R/L-0714-C45-E03	■	■	■	□	□
		0.8	1.6	10	8.5	0.14	0.72	0.36	0.40	0.05	32	BF4R/L-0816-C45-E05	■	■	■	□	□
		0.9	1.8	10	8.5	0.15	0.81	0.41	0.45	0.05	32	BF4R/L-0918-C45-E05	■	■	■	□	□
		1.0	3.0	10	8.5	0.17	0.90	0.45	0.70	0.10	32	BF4R/L-1030-C45-E10	■	■	■	□	□
		1.5	4.5	10	8.5	0.25	1.35	0.67	0.75	0.10	32	BF4R/L-1545-C45-E10	■	■	■	□	□
		2.0	6.0	10	8.5	0.34	1.80	0.90	1.15	0.20	32	BF4R/L-2060-C45-E20	■	■	■	□	□
2.5	7.5	10	8.5	0.43	2.25	1.13	1.30	0.20	32	BF4R/L-2575-C45-E20	■	■	■	□	□		
3.0	9.0	15	13.5	0.51	2.70	1.35	1.35	0.30	37	BF4R/L-3090-C45-E30	■	■	■	□	□		
3.5	10.5	15	13.5	0.60	3.15	1.58	1.60	0.30	37	BF4R/L-35105-C45-E30	■	■	■	□	□		
D h5	Holder	Ø min	L1	L2 BH6... BHY6...	L2 BHS6... BHK6...	T	B1	B2	C	E	L3	Art. N°	ZTAF	ZTAXF	ZN	ZTAF	ZN
6	BH6... BHS6... BHY6... BHK6...	4.0	12.0	20	18.5	0.68	3.80	1.90	2.30	0.40	47	BF6R/L-40120-C45-E40	■	■	■	□	□
		5.0	15.0	20	18.5	0.85	4.75	2.37	2.50	0.50	47	BF6R/L-50150-C45-E50	■	■	■	□	□

- Copiage
- Kopieren
- Chambering



## BB4... / BB6...

## C45X

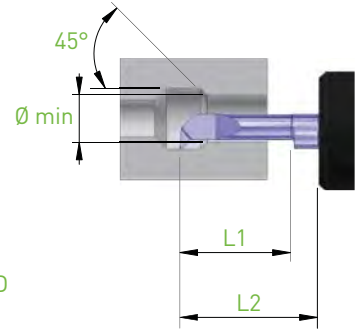
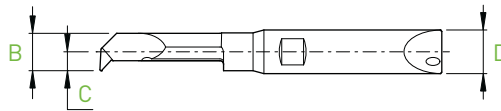
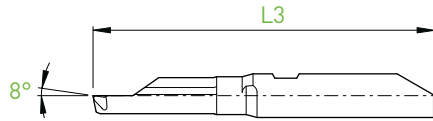
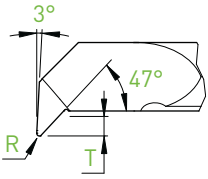

D h5	Holder	Ø min	L1	L2 BH4... BHY4...	L2 BHS4... BHK4...	T	B	C	R	L3	Art. N°	R		L		
												ZTAF	ZTAXF	ZN	ZTAF	ZN
4	BH4... BHS4... BHY4... BHK4...	2.5	7.5	10	8.5	0.50	2.25	1.35	0.10	32	<b>BB4R/L-2575-C45X-R10</b>	■	■	■	□	□
			12.5	15	13.5	0.50	2.25	1.35	0.10	37	<b>BB4R/L-25125-C45X-R10</b>	■	■	■	□	□
		3.0	9.0	15	13.5	0.60	2.70	1.45	0.10	37	<b>BB4R/L-3090-C45X-R10</b>	■	■	■	□	□
			15.0	20	18.5	0.60	2.70	1.45	0.10	42	<b>BB4R/L-30150-C45X-R10</b>	■	■	■	□	□
		3.5	10.5	15	13.5	0.70	3.15	1.60	0.10	37	<b>BB4R/L-35105-C45X-R10</b>	■	■	■	□	□
			17.5	20	18.5	0.70	3.15	1.60	0.10	42	<b>BB4R/L-35175-C45X-R10</b>	■	■	■	□	□
D h5	Holder	Ø min	L1	L2 BH6... BHY6...	L2 BHS6... BHK6...	T	B	C	R	L3	Art. N°	ZTAF	ZTAXF	ZN	ZTAF	ZN
6	BH6... BHS6... BHY6... BHK6...	4.0	12.0	20	18.5	0.80	3.80	2.30	0.15	47	<b>BB6R/L-40120-C45X-R15</b>	■	■	■	□	□
			20.0	30	28.5	0.80	3.80	2.30	0.15	57	<b>BB6R/L-40200-C45X-R15</b>	■	■	■	□	□
		4.5	13.5	20	18.5	0.90	4.28	2.40	0.15	47	<b>BB6R/L-45135-C45X-R15</b>	■	■	■	□	□
			22.5	30	28.5	0.90	4.28	2.40	0.15	57	<b>BB6R/L-45225-C45X-R15</b>	■	■	■	□	□
		5.0	15.0	20	18.5	1.00	4.75	2.50	0.15	47	<b>BB6R/L-50150-C45X-R15</b>	■	■	■	□	□
			25.0	30	28.5	1.00	4.75	2.50	0.15	57	<b>BB6R/L-50250-C45X-R15</b>	■	■	■	□	□
		5.5	16.5	20	18.5	1.10	5.15	2.60	0.15	47	<b>BB6R/L-55165-C45X-R15</b>	■	■	■	□	□
			27.5	30	28.5	1.10	5.15	2.60	0.15	57	<b>BB6R/L-55275-C45X-R15</b>	■	■	■	□	□

Copiage  
Kopieren  
Chambering



BF4... / BF6...

C45X

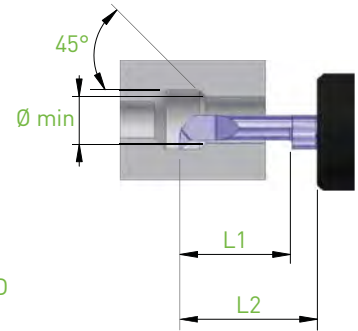
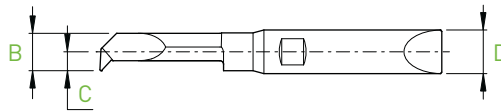
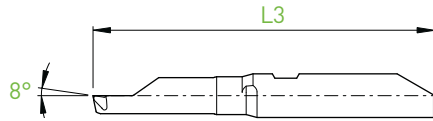
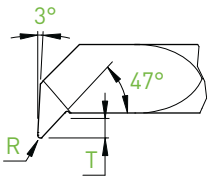

D h5	Holder	Ø min	L1	L2 BH4... BHY4...	L2 BHS4... BHK4...	T	B	C	R	L3	Art. N°	R		L		
												ZTAF	ZTAXF	ZN	ZTAF	ZN
4	BH4... BHS4... BHY4... BHK4...	2.5	7.5	10	8.5	0.50	2.25	1.35	0.10	32	<b>BF4R/L-2575-C45X-R10</b>	■	■	■	□	□
			12.5	15	13.5	0.50	2.25	1.35	0.10	37	<b>BF4R/L-25125-C45X-R10</b>	■	■	■	□	□
		3.0	9.0	15	13.5	0.60	2.70	1.45	0.10	37	<b>BF4R/L-3090-C45X-R10</b>	■	■	■	□	□
			15.0	20	18.5	0.60	2.70	1.45	0.10	42	<b>BF4R/L-30150-C45X-R10</b>	■	■	■	□	□
		3.5	10.5	15	13.5	0.70	3.15	1.60	0.10	37	<b>BF4R/L-35105-C45X-R10</b>	■	■	■	□	□
			17.5	20	18.5	0.70	3.15	1.60	0.10	42	<b>BF4R/L-35175-C45X-R10</b>	■	■	■	□	□
D h5	Holder	Ø min	L1	L2 BH6... BHY6...	L2 BHS6... BHK6...	T	B	C	R	L3	Art. N°	ZTAF	ZTAXF	ZN	ZTAF	ZN
6	BH6... BHS6... BHY6... BHK6...	4.0	12.0	20	18.5	0.80	3.80	2.30	0.15	47	<b>BF6R/L-40120-C45X-R15</b>	■	■	■	□	□
			20.0	30	28.5	0.80	3.80	2.30	0.15	57	<b>BF6R/L-40200-C45X-R15</b>	■	■	■	□	□
		4.5	13.5	20	18.5	0.90	4.28	2.40	0.15	47	<b>BF6R/L-45135-C45X-R15</b>	■	■	■	□	□
			22.5	30	28.5	0.90	4.28	2.40	0.15	57	<b>BF6R/L-45225-C45X-R15</b>	■	■	■	□	□
		5.0	15.0	20	18.5	1.00	4.75	2.50	0.15	47	<b>BF6R/L-50150-C45X-R15</b>	■	■	■	□	□
			25.0	30	28.5	1.00	4.75	2.50	0.15	57	<b>BF6R/L-50250-C45X-R15</b>	■	■	■	□	□
		5.5	16.5	20	18.5	1.10	5.15	2.60	0.15	47	<b>BF6R/L-55165-C45X-R15</b>	■	■	■	□	□
			27.5	30	28.5	1.10	5.15	2.60	0.15	57	<b>BF6R/L-55275-C45X-R15</b>	■	■	■	□	□

■ = disponible / verfügbar / available  
□ = selon disponibilité du stock / jenach Lagerverfügbarkeit / depending the stock availability

Gorge  
Einstecken  
Grooving



## BB4... / BB6...

## GX

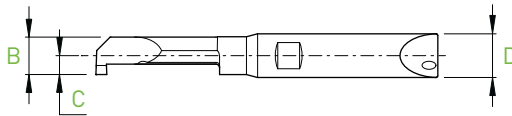
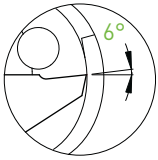
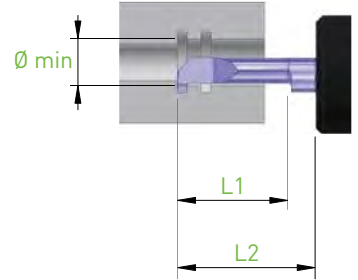
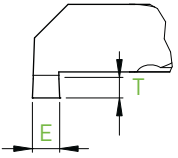

D h5	Holder	Ø min	L1	L2 BH4... BHY4...	L2 BHS4... BHK4...	E	T	B	C	L3	Art. N°	R		L			
												ZTAF	ZTAXF	ZN	ZTAF	ZN	
4	BH4... BHS4... BHY4... BHK4...	3.0	9.0	15	13.5	0.50	0.60	2.70	1.45	37	<b>BB4R/L-3090-G050X</b>	■	■	■	□	□	
			15.0	20	18.5	0.50	0.60	2.70	1.45	42	<b>BB4R/L-30150-G050X</b>	■	■	■	□	□	
	3.5	10.5	15	13.5	0.75	0.70	3.15	1.60	37	<b>BB4R/L-35105-G075X</b>	■	■	■	□	□		
		17.5	20	18.5	0.75	0.70	3.15	1.60	42	<b>BB4R/L-35175-G075X</b>	■	■	■	□	□		
D h5	Holder	Ø min	L1	L2 BH6... BHY6...	L2 BHS6... BHK6...	E	T	B	C	L3	Art. N°	ZTAF	ZTAXF	ZN	ZTAF	ZN	
6	BH6... BHS6... BHY6... BHK6...	4.0	12.0	20	18.5	1.00	0.80	3.80	2.20	47	<b>BB6R/L-40120-G100X</b>	■	■	■	□	□	
			20.0	30	28.5	1.00	0.80	3.80	2.20	57	<b>BB6R/L-40200-G100X</b>	■	■	■	□	□	
		4.5	13.5	20	18.5	1.00	0.90	4.28	2.40	47	<b>BB6R/L-45135-G100X</b>	■	■	■	□	□	
			22.5	30	28.5	1.00	0.90	4.28	2.40	57	<b>BB6R/L-45225-G100X</b>	■	■	■	□	□	
		5.0	15.0	20	18.5	1.50	1.00	4.75	2.50	47	<b>BB6R/L-50150-G100X</b>	■	■	■	□	□	
			25.0	30	28.5	1.50	1.00	4.75	2.50	57	<b>BB6R/L-50150-G150X</b>	■	■	■	□	□	
			5.5	16.5	20	18.5	1.00	1.00	5.15	2.60	47	<b>BB6R/L-55165-G100X</b>	■	■	■	□	□
							1.50	1.10	5.15	2.60	47	<b>BB6R/L-55165-G150X</b>	■	■	■	□	□
							2.00	1.10	5.15	2.60	57	<b>BB6R/L-55165-G200X</b>	■	■	■	□	□
							1.00	1.10	5.15	2.60	57	<b>BB6R/L-55275-G100X</b>	■	■	■	□	□
		27.5	30	28.5	1.50	1.10	5.15	2.60	57	<b>BB6R/L-55275-G150X</b>	■	■	■	□	□		
					2.00	1.10	5.15	2.60	57	<b>BB6R/L-55275-G200X</b>	■	■	■	□	□		

Gorge  
Einstecken  
Grooving



BF4... / BF6...

GX

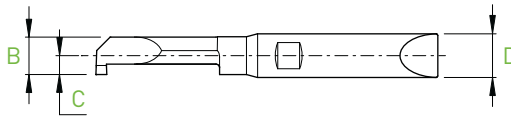
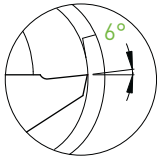
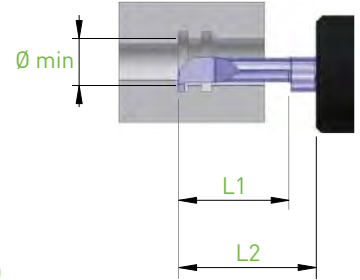
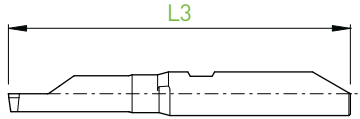
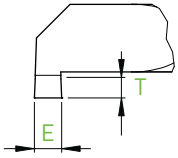

D h5	Holder	Ø min	L1	L2		E	T	B	C	L3	Art. N°	R		L		
				BH4... BHY4...	BHS4... BHK4...							ZTAF	ZTAXF	ZN	ZTAF	ZN
4	BH4... BHS4... BHY4... BHK4...	3.0	9.0	15	13.5	0.50	0.60	2.70	1.45	37	BF4R/L-3090-G050X	■	■	■	□	□
			15.0	20	18.5	0.50	0.60	2.70	1.45	42	BF4R/L-30150-G050X	■	■	■	□	□
	3.5	10.5	15	13.5	0.75	0.70	3.15	1.60	37	BF4R/L-35105-G075X	■	■	■	□	□	
		17.5	20	18.5	0.75	0.70	3.15	1.60	42	BF4R/L-35175-G075X	■	■	■	□	□	
D h5	Holder	Ø min	L1	L2		E	T	B	C	L3	Art. N°	R		L		
6	BH6... BHS6... BHY6... BHK6...	4.0	12.0	20	18.5							1.00	0.80	3.80	2.20	47
			20.0	30	28.5	1.00	0.80	3.80	2.20	57	BF6R/L-40200-G100X	■	■	■	□	□
		4.5	13.5	20	18.5	1.00	0.90	4.28	2.40	47	BF6R/L-45135-G100X	■	■	■	□	□
						1.50					BF6R/L-45135-G150X	■	■	■	□	□
		5.0	15.0	20	18.5	1.00	1.00	4.75	2.50	47	BF6R/L-45225-G100X	■	■	■	□	□
						1.50					BF6R/L-45225-G150X	■	■	■	□	□
		5.5	16.5	20	18.5	1.00	1.10	5.15	2.60	47	BF6R/L-50150-G100X	■	■	■	□	□
						1.50					BF6R/L-50150-G150X	■	■	■	□	□
			25.0	30	28.5	1.00	1.00	4.75	2.50	57	BF6R/L-50250-G100X	■	■	■	□	□
						1.50					BF6R/L-50250-G150X	■	■	■	□	□
			27.5	30	28.5	1.00	1.10	5.15	2.60	57	BF6R/L-55165-G100X	■	■	■	□	□
						1.50					BF6R/L-55165-G150X	■	■	■	□	□
						2.00					BF6R/L-55165-G200X	■	■	■	□	□
						1.00					BF6R/L-55275-G100X	■	■	■	□	□
		1.50	1.10	5.15	2.60	57	BF6R/L-55275-G150X	■	■	■	□	□				
							2.00	BF6R/L-55275-G200X	■	■	■	□	□			

■ = disponible / verfügbar / available  
□ = selon disponibilité du stock / jenach Lagerverfügbarkeit / depending the stock availability

# IN-LINE

Fonçage-tournage  
Einstecken und drehen  
Grooving and turning



BB4... / BB6...

GTX

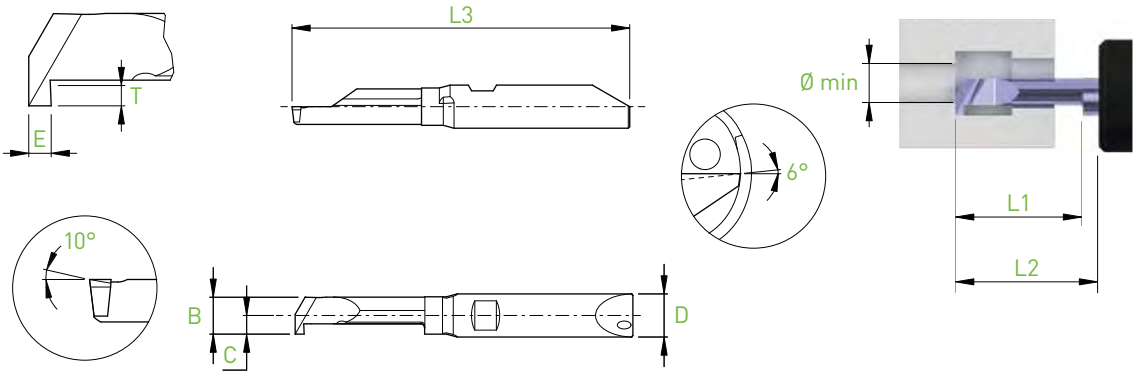

D h5	Holder	Ø min	L1	L2 BH4... BHY4...	L2 BHS4... BHK4...	E	T	B	C	L3	Art. N°	R		L		
												ZTAF	ZTAXF	ZN	ZTAF	ZN
4	BH4... BHS4... BHY4... BHK4...	3.0	9.0	15	13.5	1.00	0.60	2.7	1.45	37	BB4R/L-3090-GT100X	■	■	■	□	□
			15.0	20	18.5	1.00	0.60	2.7	1.45	42	BB4R/L-30150-GT100X	■	■	■	□	□
	3.5	10.5	15	13.5	1.00	0.70	3.15	1.6	37	BB4R/L-35105-GT100X	■	■	■	□	□	
		17.5	20	18.5	1.00	0.70	3.15	1.6	42	BB4R/L-35175-GT100X	■	■	■	□	□	
D h5	Holder	Ø min	L1	L2 BH6... BHY6...	L2 BHS6... BHK6...	E	T	B	C	L3	Art. N°	ZTAF	ZTAXF	ZN	ZTAF	ZN
6	BH6... BHS6... BHY6... BHK6...	4.0	14.0	20	18.5	1.25	0.80	3.8	2.2	47	BB6R/L-40140-GT125X	■	■	■	□	□
			22.0	30	28.5	1.25	0.80	3.8	2.2	57	BB6R/L-40220-GT125X	■	■	■	□	□
		4.5	16.0	20	18.5	1.25	0.90	4.28	2.4	47	BB6R/L-45160-GT125X	■	■	■	□	□
			25.0	30	28.5	1.25	0.90	4.28	2.4	57	BB6R/L-45250-GT125X	■	■	■	□	□
		5.0	17.5	20	18.5	1.25	1.00	4.75	2.5	47	BB6R/L-50175-GT125X	■	■	■	□	□
			27.5	30	28.5	1.25	1.00	4.75	2.5	57	BB6R/L-50275-GT125X	■	■	■	□	□
		5.5	17.5	20	18.5	1.25	1.10	5.15	2.6	47	BB6R/L-55175-GT125X	■	■	■	□	□
			27.5	30	28.5	1.25	1.10	5.15	2.6	57	BB6R/L-55275-GT125X	■	■	■	□	□

Fonçage-tournage

Einstechen und drehen

Grooving and turning



BF4... / BF6...

GTX

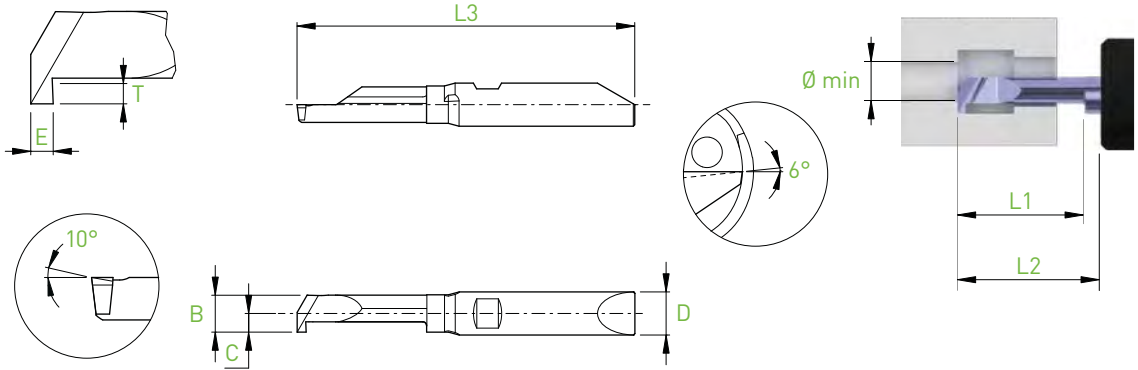

D h5	Holder	Ø min	L1	L2 BH4... BHY4...	L2 BHS4... BHK4...	E	T	B	C	L3	Art. N°	R		L		
												ZTAF	ZTAXF	ZN	ZTAF	ZN
4	BH4... BHS4... BHY4... BHK4...	3.0	9.0	15	13.5	1.00	0.60	2.7	1.45	37	BF4R/L-3090-GT100X	■	■	■	□	□
			15.0	20	18.5	1.00	0.60	2.7	1.45	42	BF4R/L-30150-GT100X	■	■	■	□	□
	3.5	10.5	15	13.5	1.00	0.70	3.15	1.6	37	BF4R/L-35105-GT100X	■	■	■	□	□	
		17.5	20	18.5	1.00	0.70	3.15	1.6	42	BF4R/L-35175-GT100X	■	■	■	□	□	
D h5	Holder	Ø min	L1	L2 BH6... BHY6...	L2 BHS6... BHK6...	E	T	B	C	L3	Art. N°	ZTAF	ZTAXF	ZN	ZTAF	ZN
6	BH6... BHS6... BHY6... BHK6...	4.0	14.0	20	18.5	1.25	0.80	3.8	2.2	47	BF6R/L-40140-GT125X	■	■	■	□	□
			22.0	30	28.5	1.25	0.80	3.8	2.2	57	BF6R/L-40220-GT125X	■	■	■	□	□
		4.5	16.0	20	18.5	1.25	0.90	4.28	2.4	47	BF6R/L-45160-GT125X	■	■	■	□	□
			25.0	30	28.5	1.25	0.90	4.28	2.4	57	BF6R/L-45250-GT125X	■	■	■	□	□
		5.0	17.5	20	18.5	1.25	1.00	4.75	2.5	47	BF6R/L-50175-GT125X	■	■	■	□	□
			27.5	30	28.5	1.25	1.00	4.75	2.5	57	BF6R/L-50275-GT125X	■	■	■	□	□
		5.5	17.5	20	18.5	1.25	1.10	5.15	2.6	47	BF6R/L-55175-GT125X	■	■	■	□	□
			27.5	30	28.5	1.25	1.10	5.15	2.6	57	BF6R/L-55275-GT125X	■	■	■	□	□

■ = disponible / verfügbar / available

□ = selon disponibilité du stock / jenach Lagerverfügbarkeit / depending the stock availability



# IN-LINE

Filetage  
Gewindedrehen  
Threading



BB4... / BB6...

TP60

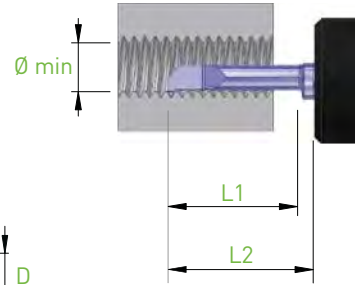
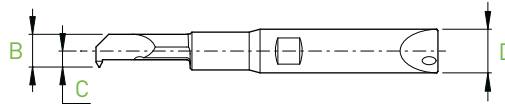
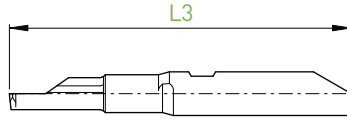
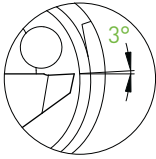
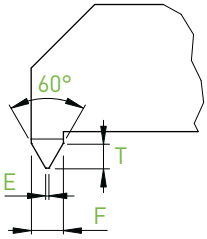

D h5	Holder	Ø min	L1	L2 BH4... BHY4...	L2 BHS4... BHK4...	P (mm)	P (TPI)	F	E (0/-0.01)	T	B	C	L3	Art. N°	R		L	
															ZTAF ZN	ZTAF ZN		
4	BH4... BHS4... BHY4... BHK4...	1.25	3.2	10	8.5	0.20-0.35	80	0.30	0.02	0.25	1.10	0.80	32	BB4R/L-1232-TP60	■	■	□	□
		1.6	4.0	10	8.5	0.25-0.40	72-64	0.35	0.03	0.28	1.41	0.90	32	BB4R/L-1640-TP60	■	■	□	□
		2.5	6.0	10	8.5	0.35-0.50	56-48	0.44	0.04	0.34	2.25	1.35	32	BB4R/L-2560-TP60	■	■	□	□
			9.0	15	13.5	0.35-0.50	56-48	0.44	0.04	0.34	2.25	1.35	37	BB4R/L-2590-TP60	■	■	□	□
		3.3	8.0	15	13.5	0.50-0.75	40-36	0.62	0.06	0.48	2.97	1.50	37	BB4R/L-3380-TP60	■	■	□	□
			12.0	15	13.5	0.50-0.75	40-36	0.62	0.06	0.48	2.97	1.50	37	BB4R/L-33120-TP60	■	■	□	□
D h5	Holder	Ø min	L1	L2 BH6... BHY6...	L2 BHS6... BHK6...	P (mm)	P (TPI)	F	E (0/-0.01)	T	B	C	L3	Art. N°	R		L	
															ZTAF ZN	ZTAF ZN		
6	BH6... BHS6... BHY6... BHK6...	4.2	10.0	20	18.5	0.50-0.80	36-32	0.70	0.06	0.55	3.78	2.10	47	BB6R/L-42100-TP60	■	■	□	□
			15.0	20	18.5	0.50-0.80	36-32	0.70	0.06	0.55	3.78	2.10	47	BB6R/L-42150-TP60	■	■	□	□
		5.0	12.0	20	18.5	0.75-1.00	28-24	0.89	0.09	0.69	4.50	2.20	47	BB6R/L-50120-TP60	■	■	□	□
			18.0	20	18.5	0.75-1.00	28-24	0.89	0.09	0.69	4.50	2.20	47	BB6R/L-50180-TP60	■	■	□	□

Filetage

Gewindedrehen

Threading



BF4... / BF6...

TP60

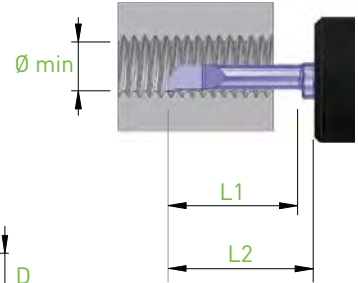
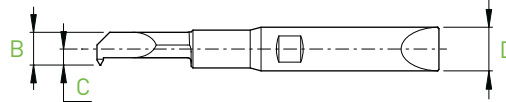
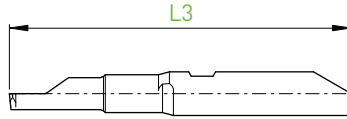
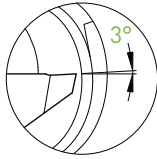
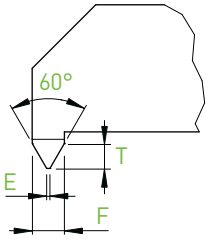

D h5	Holder	Ø min	L1	L2 BH4... BHY4...	L2 BHS4... BHK4...	P (mm)	P (TPI)	F	E (0/-0.01)	T	B	C	L3	Art. N°	R		L	
															ZTAF ZN	ZTAF ZN		
4	BH4... BHS4... BHY4... BHK4...	1.25	3.2	10	8.5	0.20-0.35	80	0.30	0.02	0.25	1.10	0.80	32	BF4R/L-1232-TP60	■	■	□	□
		1.6	4.0	10	8.5	0.25-0.40	72-64	0.35	0.03	0.28	1.41	0.90	32	BF4R/L-1640-TP60	■	■	□	□
		2.5	6.0	10	8.5	0.35-0.50	56-48	0.44	0.04	0.34	2.25	1.35	32	BF4R/L-2560-TP60	■	■	□	□
			9.0	15	13.5	0.35-0.50	56-48	0.44	0.04	0.34	2.25	1.35	37	BF4R/L-2590-TP60	■	■	□	□
		3.3	8.0	15	13.5	0.50-0.75	40-36	0.62	0.06	0.48	2.97	1.50	37	BF4R/L-3380-TP60	■	■	□	□
			12.0	15	13.5	0.50-0.75	40-36	0.62	0.06	0.48	2.97	1.50	37	BF4R/L-33120-TP60	■	■	□	□
D h5	Holder	Ø min	L1	L2 BH6... BHY6...	L2 BHS6... BHK6...	P (mm)	P (TPI)	F	E (0/-0.01)	T	B	C	L3	Art. N°	R		L	
															ZTAF ZN	ZTAF ZN		
6	BH6... BHS6... BHY6... BHK6...	4.2	10.0	20	18.5	0.50-0.80	36-32	0.70	0.06	0.55	3.78	2.10	47	BF6R/L-42100-TP60	■	■	□	□
			15.0	20	18.5	0.50-0.80	36-32	0.70	0.06	0.55	3.78	2.10	47	BF6R/L-42150-TP60	■	■	□	□
		5.0	12.0	20	18.5	0.75-1.00	28-24	0.89	0.09	0.69	4.50	2.20	47	BF6R/L-50120-TP60	■	■	□	□
			18.0	20	18.5	0.75-1.00	28-24	0.89	0.09	0.69	4.50	2.20	47	BF6R/L-50180-TP60	■	■	□	□

■ = disponible / verfügbar / available

□ = selon disponibilité du stock / jenach Lagerverfügbarkeit / depending the stock availability

# IN-LINE

Filetage  
Gewindedrehen  
Threading



**BB4... / BB6...**

**TP55**

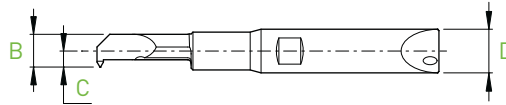
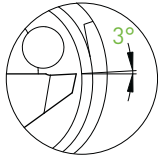
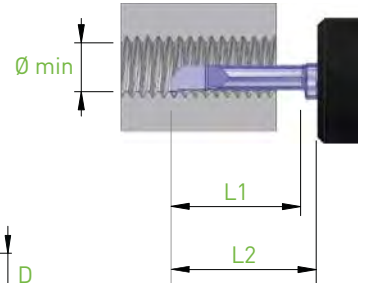
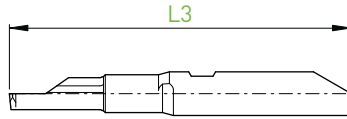
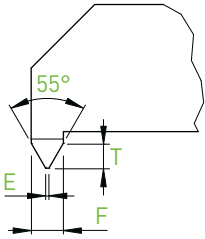

D <sub>h5</sub>	Holder	Ø min	L1	L2 BH4... BHY4...	L2 BHS4... BHK4...	P (TPI)	F	E (0/-0.02)	T	B	C	L3	Art. N°	R		L	
														ZTAF ZN	ZTAF ZN	ZTAF ZN	ZTAF ZN
4	BH4...	1.85	4.5	10	8.5	48	0.54	0.09	0.44	1.67	0.97	32	<b>BB4R/L-1845-TP55</b>	■	■	□	□
	BHS4...																
	BHY4... BHK4...	2.55	6.0	10	8.5	40	0.64	0.10	0.52	2.25	1.35	32	<b>BB4R/L-2560-TP55</b>	■	■	□	□
6	BH6...	3.70	11.0	20	18.5	32-24	1.08	0.13	0.91	3.33	1.83	47	<b>BB6R/L-37110-TP55</b>	■	■	□	□
	BHS6...	5.10	15.0	20	18.5	26-20	1.30	0.16	1.09	4.60	2.05	47	<b>BB6R/L-51150-TP55</b>	■	■	□	□
	BHY6...																
	BHK6...	5.50	16.0	20	18.5	22-16	1.48	0.19	1.24	5.15	2.60	47	<b>BB6R/L-55160-TP55</b>	■	■	□	□

**Filetage**  
**Gewindedrehen**  
**Threading**



**BF4... / BF6...**

**TP55**

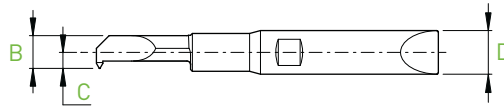
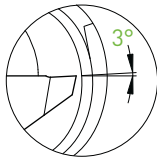
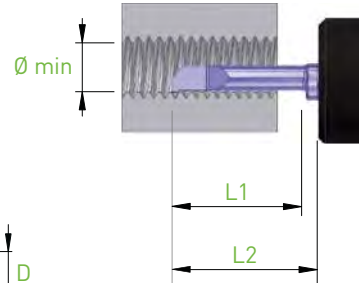
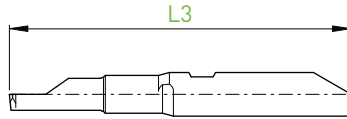
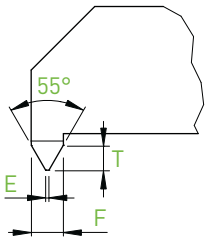

													R		L		
D <sub>h5</sub>	Holder	Ø min	L1	L2 BH4... BHY4...	L2 BHS4... BHK4...	P (TPI)	F	E (0/-0.02)	T	B	C	L3	Art. N°	ZTAF ZN	ZTAF ZN		
4	BH4...	1.85	4.5	10	8.5	48	0.54	0.09	0.44	1.67	0.97	32	<b>BF4R/L-1845-TP55</b>	■	■	□	□
	BHS4...													■	■	□	□
	BHY4... BHK4...	2.55	6.0	10	8.5	40	0.64	0.10	0.52	2.25	1.35	32	<b>BF4R/L-2560-TP55</b>	■	■	□	□
D <sub>h5</sub>	Holder	Ø min	L1	L2 BH6... BHY6...	L2 BHS6... BHK6...	P (TPI)	F	E (0/-0.02)	T	B	C	L3	Art. N°	ZTAF ZN	ZTAF ZN		
6	BH6...	3.70	11.0	20	18.5	32-24	1.08	0.13	0.91	3.33	1.83	47	<b>BF6R/L-37110-TP55</b>	■	■	□	□
	BHS6...	5.10	15.0	20	18.5	26-20	1.30	0.16	1.09	4.60	2.05	47	<b>BF6R/L-51150-TP55</b>	■	■	□	□
	BHY6... BHK6...	5.50	16.0	20	18.5	22-16	1.48	0.19	1.24	5.15	2.60	47	<b>BF6R/L-55160-TP55</b>	■	■	□	□

■ = disponible / verfügbar / available  
□ = selon disponibilité du stock / jenach Lagerverfügbarkeit / depending the stock availability



Profil complet métrique  
Metrisches Vollprofil  
Metric full profile

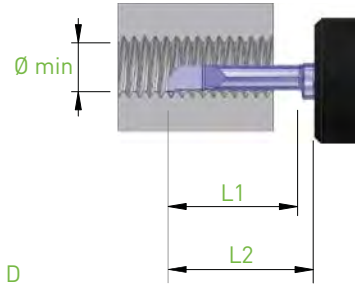
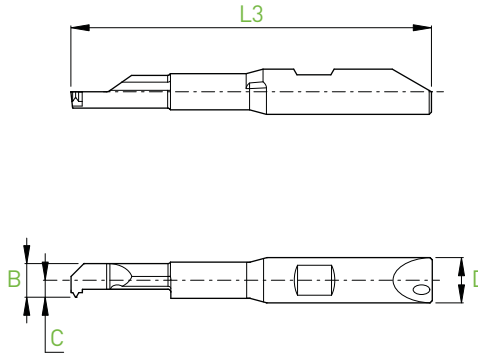
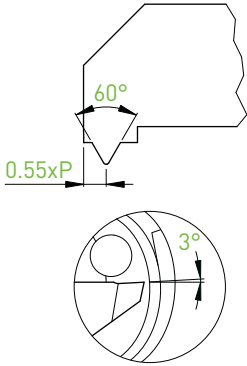

R

D h5	Holder	M (min)	$\emptyset$ min	P (mm)	L1	L2 BH4... BHY4...	L2 BHS4... BHK4...	B	C	L3	Art. N°	ZTAF	ZN
4	BH4... BHS4... BHY4... BHK4...	M3x0.5	2.50	0.50	6.0	10	8.5	2.25	1.35	32	<b>BB4R-2560-TM-0.50</b>	■	■
		M4x0.7	3.30	0.70	8.0	15	13.5	2.97	1.50	37	<b>BB4R-3380-TM-0.70</b>	■	■
D h5	Holder	M (min)	$\emptyset$ min	P (mm)	L1	L2 BH6... BHY6...	L2 BHS6... BHK6...	B	C	L3	Art. N°	ZTAF	ZN
6	BH6... BHS6... BHY6... BHK6...	M5x0.8	4.20	0.80	10.0	20	18.5	3.78	2.10	47	<b>BB6R-42100-TM-0.80</b>	■	■
		M6x1.0	5.00	1.00	12.0	20	18.5	4.50	2.20	47	<b>BB6R-50120-TM-1.00</b>	■	■

Filetage

Gewindedrehen

Threading



BF4... / BF6...

TM

Profil complet métrique

Metrisches Vollprofil

Metric full profile

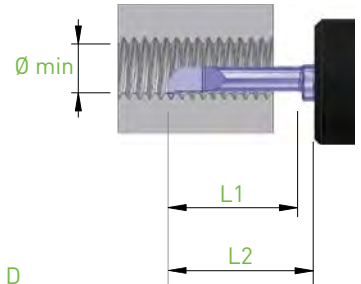
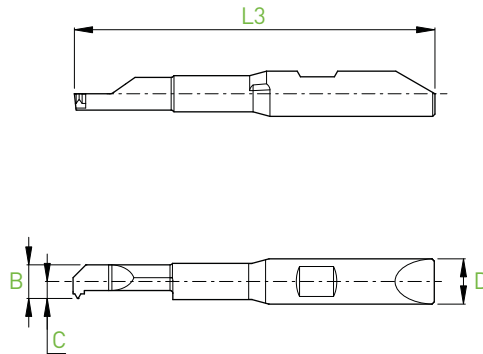
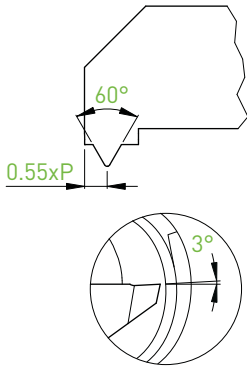

R

D h5	Holder	M (min)	Ø min	P (mm)	L1	L2 BH4... BHY4...	L2 BHS4... BHK4...	B	C	L3	Art. N°	ZTAF	ZN
4	BH4... BHS4...	M3x0.5	2.50	0.50	6.0	10	8.5	2.25	1.35	32	<b>BF4R-2560-TM-0.50</b>	■	■
	BHY4... BHK4...	M4x0.7	3.30	0.70	8.0	15	13.5	2.97	1.50	37	<b>BF4R-3380-TM-0.70</b>	■	■
D h5	Holder	M (min)	Ø min	P (mm)	L1	L2 BH6... BHY6...	L2 BHS6... BHK6...	B	C	L3	Art. N°	ZTAF	ZN
6	BH6... BHS6...	M5x0.8	4.20	0.80	10.0	20	18.5	3.78	2.10	47	<b>BF6R-42100-TM-0.80</b>	■	■
	BHY6... BHK6...	M6x1.0	5.00	1.00	12.0	20	18.5	4.50	2.20	47	<b>BF6R-50120-TM-1.00</b>	■	■

■ = disponible / verfügbar / available

□ = selon disponibilité du stock / jenach Lagerverfügbarkeit / depending the stock availability

# IN-LINE

- Gorge frontale extérieure
- Aussen axiales stechen
- External axial grooving



**BB6...**

**FEG**

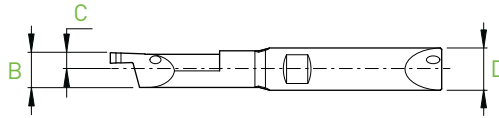
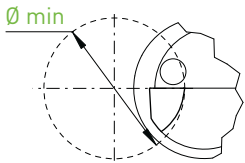
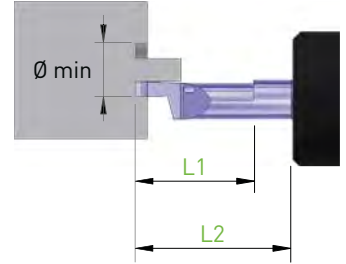
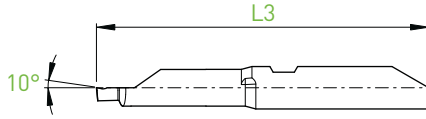
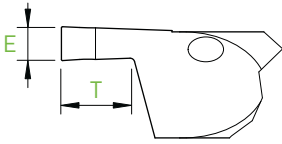

**R**

D h5	Holder	Ø min	L1	L2 BH6... BHY6...	L2 BHS6... BHK6...	T	B	C	E	L3	Art. N°	ZTAF	ZN
6	BH6... BHS6... BHY6... BHK6...	5.0	15.0	20	18.5	3.00	4.90	2.30	1.50	47	<b>BB6R-50150-FEG150X</b>	■	■

Gorge frontale intérieure

Innen axiales stechen

Internal axial grooving



BB6...

FIG

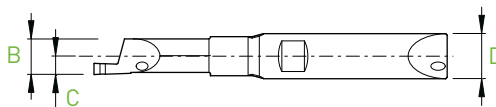
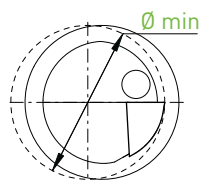
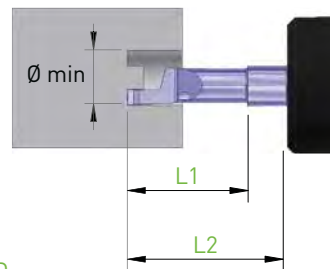
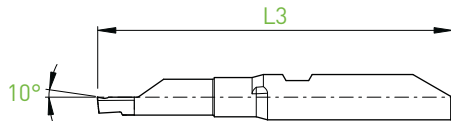
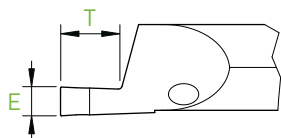

R

D h5	Holder	Ø min	L1	L2 BH6... BHY6...	L2 BHS6... BHK6...	T	B	C	E	L3	Art. N°	ZTAF	ZN
6	BH6... BHS6... BHY6... BHK6...	5.0	15.0	20	18.5	3.00	4.75	2.45	1.50	47	BB6R-50150-FIG150X	■	■

■ = disponible / verfügbar / available

□ = selon disponibilité du stock / jenach Lagerverfügbarkeit / depending the stock availability



# IN-LINE

Ébauches avec arrosage  
 Rohlinge mit Kühlung  
 Blanks with coolant



**BB4... / BB6...**

**BB\_E**

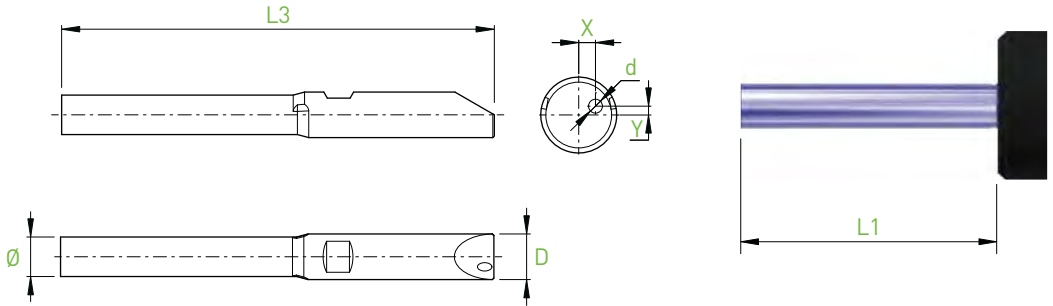

$D_{h5}$	Holder	L1 BH4... BHY4...	L1 BHS4... BHK4...	$\emptyset$	X	Y	d	L3	Art. N°	ZN
4	BH4... BHS4... BHY4... BHK4...	20.0	18.5	3.20	0.84	0.55	0.85	42	<b>BB4R-E42</b>	■
$D_{h5}$	Holder	L1 BH6... BHY6...	L1 BHS6... BHK6...	$\emptyset$	X	Y	d	L3	Art. N°	ZN
6	BH6... BHS6... BHY6... BHK6...	30.0	28.5	5.20	1.33	0.70	1.10	57	<b>BB6R-E57</b>	■

Ébauches

Rohlinge

Blanks



BF4... / BF6...

BF\_E

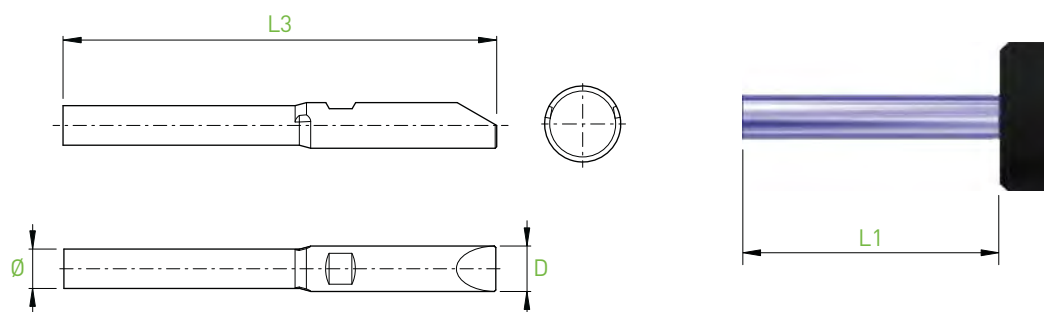

$D_{h5}$	Holder	L1 BH4... BHY4...	L1 BHS4... BHK4...	$\emptyset$	L3	Art. N°	ZN
4	BH4... BHS4... BHY4... BHK4...	20.0	18.5	3.20	42	BF4-E42	■
$D_{h5}$	Holder	L1 BH6... BHY6...	L1 BHS6... BHK6...	$\emptyset$	L3	Art. N°	ZN
6	BH6... BHS6... BHY6... BHK6...	30.0	28.5	5.20	57	BF6-E57	■

# IN-LINE

Jauges d'alignement

Richtplatten

Adjusting tools

## MASTER

## BH4 / BH6

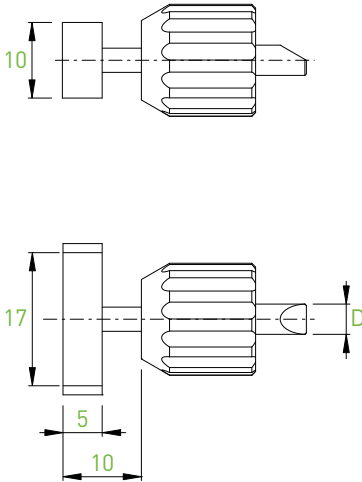

D h5	Art. N°	
4	BH4-MASTER	■
6	BH6-MASTER	■

Jauges d'alignement

Richtplatten

Adjusting tools

## MASTER

## BHSY...

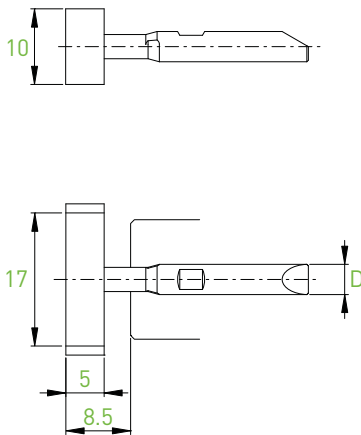

D h5	Art. N°	
4	BHSY4-MASTER	■
6	BHSY6-MASTER	■

Porte-outils avec arrosage pour contre-opération - Machines STAR  
 Halter mit Kühlungssystem zur Gegenbearbeitung – STAR-Maschinen  
 Backworking holders with through coolant – STAR-Machines

BH4 / BH6  
 BHS4 / BHS6

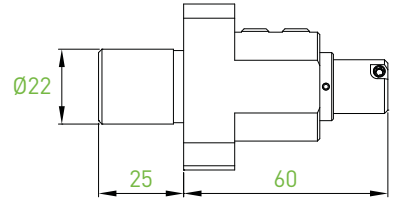
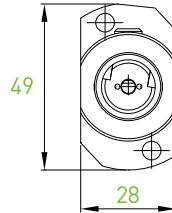

Art. N°

BWD1-2022-STAR-SRR



Art. N°

BHS4-D20-55-BWD1  
 BHS6-D20-55-BWD1

Types of STAR machines

SR10J (T22+T24)  
 SB16/20 Types C + D + E (T21-T24)  
 SB20R Types E + G + N (T21-T24)  
 SR20J / JN (T21-T24)  
 SR20R / II / III (T21-T24)  
 SR20R IV (T21-T24)  
 SR32J/JN (T21-T24)  
 SW12RII (T21-T24)  
 SV20R (T21-T24)  
 ECAS12/20 (T21-T24)  
 SW20 (T21-T23)

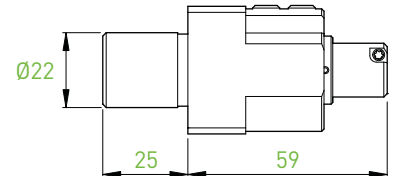
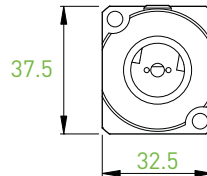

Art. N°

BWD1-2022-STAR-SW



Art. N°

BHS4-D20-55-BWD1  
 BHS6-D20-55-BWD1

Types of STAR machines

SW12RII (T21-T28)  
 SW20 (T21-T23 + T25-T27)  
 SV20R (T21-T28)  
 SR-20R IV (T21-T28)  
 SB12/20R (T22-T24)  
 SR38 (T21-T28)

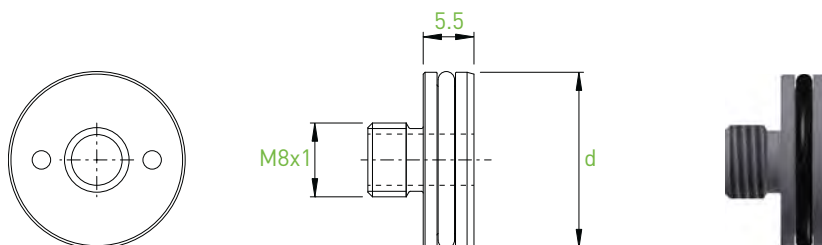

d	Art. N°	
19.05	JB-M8x1-D19.05	■
20	JB-M8x1-D20	■
22	JB-M8x1-D22	■
25	JB-M8x1-D25	■
25.4	JB-M8x1-D25.4	■